

FACTORY I.D. CIRCUIT NUMBERS

CIRCUIT I.D. NUMBERS

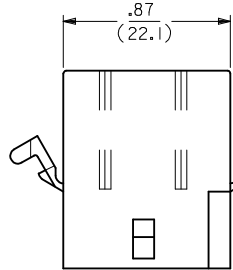

OPTIONAL MOUNTING EAR (PREBENT EAR SHOWN)

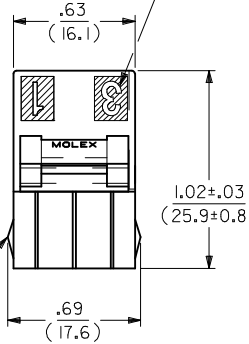

OPTIONAL LOCKING RAMPS

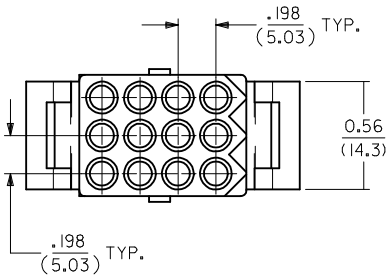

RECEPTACLE

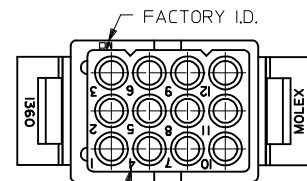
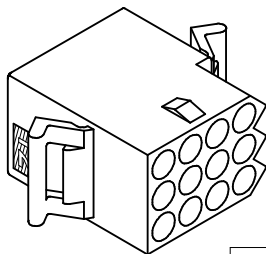

FACTORY I.D.

CIRCUIT NUMBERS

CIRCUIT I.D. NUMBERS

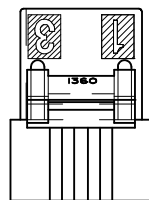

OPTIONAL MOUNTING EAR (PREBENT EAR SHOWN)

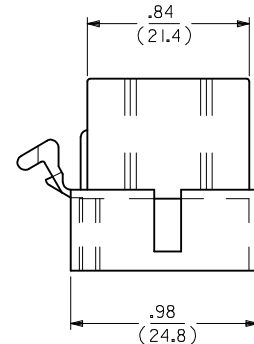

0.42 (10.7)

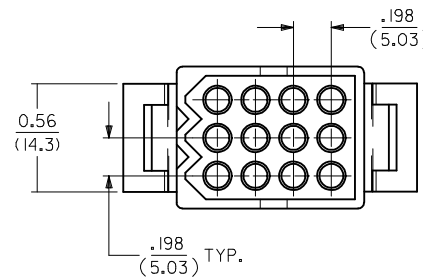
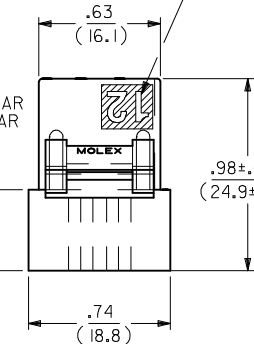

PLUG

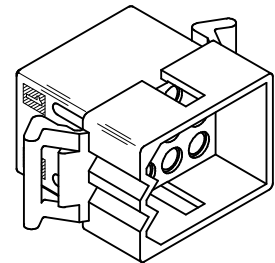

OBsolete 1360-R1* EC NO: UCP2015-1850 DRWN:JFOX 2014/11/03 CHKD:HKIPPER 2014/11/03 APPR:FSMITH 2014/11/13	QUALITY SYMBOLS	GENERAL TOLERANCES (UNLESS SPECIFIED)	DIMENSION STYLE	SCALE	DESIGN UNITS	THIRD ANGLE PROJECTION	
	$\nabla = 0$ $\nabla = 0$ $\nabla = 0$	mm INCH 4 PLACES ± --- ± --- 3 PLACES ± --- ± .010 2 PLACES ± 0.25 ± .014 1 PLACE ± 0.35 ± --- 0 PLACE ± --- ± ---	IN/MM	DRAWN BY DATE	2:1	INCH	
	0	ANGULAR ± 2°		KBW 3/1/89			
	0	DRAFT WHERE APPLICABLE MUST REMAIN WITHIN DIMENSIONS		CHECKED BY DATE			
	AE2			RW 3/1/89			
			APPROVED BY DATE				
			FSMITH 2014/11/13				
			MATERIAL NO.				
			SEE CHART				
			SIZE				
			C				

TITLE
 .093/(2.36) HOUSINGS
 PLUG AND RECEPTACLE
 12 CKT, .198/(5.03)CTR.
molex
 DOCUMENT NO. SD-1360-*
 SHEET NO. 1 OF 2

PLUG		
ORDER NO	ENG NO	
03-09-2121	I360-P	
03-09-2122 Δ	I360-PI	
03-09-7121	I360-PBK	
03-09-7122 Δ	I360-PIBK	OBSOLETE

RECEPTACLE		
ORDER NO	ENG NO	
03-09-1121	I360-R Δ	
03-09-1122	I360-R1	OBSOLETE
03-09-1125	I360-R2 Δ	
03-09-1126	I360-R3	
03-09-6121	I360-RBK	
03-09-6122	I360-RIBK	OBSOLETE
03-09-6125	I360-R2BK	
03-09-6126	I360-R3BK	
03-09-6123	I360-RIRD	OBSOLETE
03-09-6124	I360-RIYW	OBSOLETE

LEGEND: PLUG

I360-P***

P = PLUG

BLANK = WITHOUT EARS
I = WITH MOUNTING EARS

COLOR:

BLANK = NATURAL COLOR
AM = AMBER BK = BLACK BU = BLUE
BN = BROWN GY = GRAY GN = GREEN
OR = ORANGE RD = RED YW = YELLOW

LEGEND: RECEPTACLE

I360-R***

R = RECEPTACLE

OPTION	PREBENT EARS	LOCKING RAMP
BLANK	X	
1		
2	X	X
3		X

X = PRESENT

COLOR:

BLANK = NATURAL COLOR
AM = AMBER BK = BLACK BU = BLUE
BN = BROWN GY = GRAY GN = GREEN
OR = ORANGE RD = RED YW = YELLOW

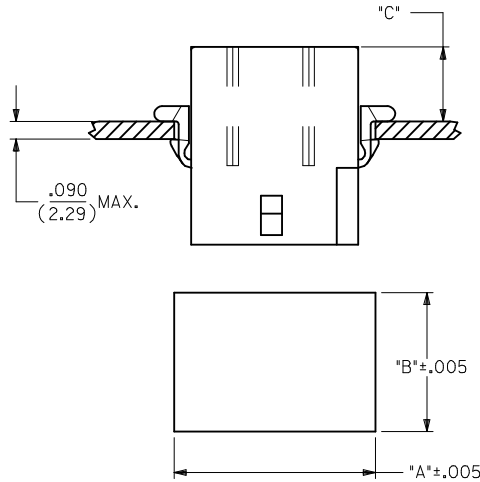

RECOMMENDED PANEL OPENING

HOUSING	DIM. "A"	DIM. "B"	"C" PREBENT EAR	"C" STANDARD EAR
PLUG	1.155/(29.34)	.760/(19.30)	.40/(10.2)	.36/(9.1)
RECEPT.	1.050/(26.67)	.725/(18.42)	.41/(10.4)	.37/(9.4)

- NOTES:
- MATERIAL: NYLON TYPE 6/6, UL94V-2
 - FINISH: N/A
 - PRODUCT SPECIFICATION: PS-02-09, PS-43660-9999
 - PACKAGING SPECIFICATION: PK-1360-001
 - Δ CIRCUIT I.D. NUMBERS ON SIDE OF HOUSING APPEAR ON PARTS FROM TOOLS BUILT AFTER 10/22/91
 - Δ WHERE DENOTED IN CHART, TOOLS ARE BUILT WITH PREBENT MOUNTING EARS PER DETAIL B AND SUPERSEDE ALL TOOLS PREVIOUSLY BUILT WITH THE STANDARD EARS.
 - PARTS CONFORM TO CLASS B REQUIREMENTS OF COSMETIC SPECIFICATION PS-45499-002.

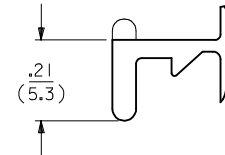

DETAIL A
.093/(2.36) STANDARD MOUNTING EAR
(SCALE 4:1)

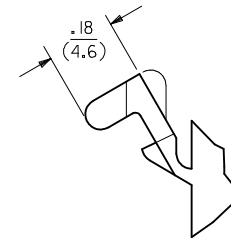
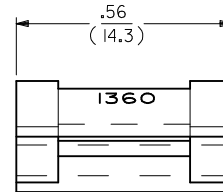

DETAIL B
.093/(2.36) PREBENT MOUNTING EAR
(SCALE 4:1)

SEE SHEET 1 EC NO: UCP2015-1850 DRWN:JDOX 2014/11/03 CHKD:HKIPPER 2014/11/03 APPR:FSMITH 2014/11/13	QUALITY SYMBOLS $\nabla=0$ $\nabla=0$ $\nabla=0$	GENERAL TOLERANCES (UNLESS SPECIFIED)		DIMENSION STYLE	SCALE	DESIGN UNITS	THIRD ANGLE PROJECTION		
				IN/MM	2:1	INCH			
				DRAWN BY	DATE	TITLE			
				CHECKED BY	DATE	.093/(2.36) HOUSINGS PLUG AND RECEPTACLE 12 CKT, .198/(5.03)CTR.			
AE2	REV	ANGULAR $\pm 2^\circ$		MATERIAL NO.	DOCUMENT NO.	SHEET NO.			
		DRAFT WHERE APPLICABLE MUST REMAIN WITHIN DIMENSIONS		SEE CHART	SD-1360-*	2 OF 2			
				THIS DRAWING CONTAINS INFORMATION THAT IS PROPRIETARY TO MOLEX INCORPORATED AND SHOULD NOT BE USED WITHOUT WRITTEN PERMISSION					
				MOLEX					