

NOTES:
 1. MATERIAL:
 SHIELD: DEEP DRAW STEEL,
 HOUSING: LCP, UL94V-0, NATURAL (WHITE),
 TAIL ALIGNER: LCP, UL94V-0, NATURAL (WHITE),
 CONTACT: COPPER ALLOY.
 2. PLATING: SEE SHEET 2.
 3. PRODUCT CONFORMS TO MOLEX PRODUCT SPECIFICATION NUMBER PS-74320-001. REFER TO THIS SPECIFICATION FOR SPACING ON A P.C.B. OF TWO OR MORE CONNECTORS WHEN USING A CABLE OR AN ADAPTER ASSEMBLY.
 4. SEE SHEET 2 FOR RECOMMENDED PANEL CUT-OUT AND P.C.B. LAYOUT.
 5. PARTS WILL BE PACKAGED IN TRAYS PER PK-74320-010.
 6. PRODUCT CONFORMS TO DDWG DVI SPECIFICATION. REFER TO THIS SPECIFICATION FOR CONNECTOR MATING DIMENSIONS.
 7. RECOMMENDED MOUNTING HARDWARE IS MOLEX P/N 71781-0001 OR 82007-0300 OR 88780-6066. REFER TO PRODUCT SPECIFICATION NUMBER PS-74320-001 FOR THIS APPLICATION TORQUE REQUIREMENT FOR ASSMBLING MOUNTING HARDWARE.
 ⚠️ CAVITY ID AND MANUFACTURING PLANT CODE.

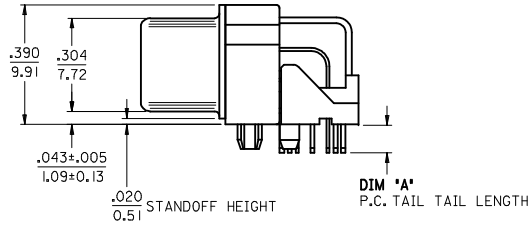

PART NUMBER	PLATING OPTION	DIM A	DIM B
74320-1000	1	0.092/2.34	0.080±0.020
74320-1001	1	0.050/1.27	2.03±0.51
74320-1003	1	0.123/3.12	0.110/2.79
74320-1004	2	0.092/2.34	0.080±0.020
74320-1005	2	0.050/1.27	2.03±0.51
74320-1006	2	0.110/2.79	0.110/2.79
74320-1007	2	0.123/3.12	0.110/2.79

REVISED	EC NO: SH2015-0200	2014/12/10
DRWN: XQZHANG	2014/12/10	
CHKD: XQZHANG	2014/12/10	
APPR: AYIN	2015/02/09	
REV	DESCRIPTION	

QUALITY SYMBOLS	GENERAL TOLERANCES (UNLESS SPECIFIED)	
	mm	INCH
$F_{\Delta} = 0$	4 PLACES ± --- ± ---	± --- ± ---
$F_{\square} = 0$	3 PLACES ± --- ± 0.010	± 0.010 ± 0.010
$F_{\nabla} = 0$	2 PLACES ± 0.25 ± 0.010	± 0.010 ± 0.010
	1 PLACE ± 0.25 ± 0.010	± --- ± ---
	0 PLACE ± --- ± ---	
	ANGULAR ± 0.5°	
	DRAFT WHERE APPLICABLE MUST REMAIN WITHIN DIMENSIONS	

DIMENSION STYLE		SCALE	DESIGN UNITS	THIRD ANGLE PROJECTION
IN/MM		1:1	INCH	
DRAWN BY	DATE	TITLE		
XQZHANG	2014/12/10	DVI - INTERGRATED RIGHT ANGLE RECEPTACLE CONNECTOR		
CHECKED BY	DATE			
XQZHANG	2014/12/10	molex		
APPROVED BY	DATE			
AYIN	2015/02/09	MATERIAL NO.	DOCUMENT NO.	SHEET NO.
		SEE TABLE	SD-74320-001	1 OF 2

THIS DRAWING CONTAINS INFORMATION THAT IS PROPRIETARY TO MOLEX INCORPORATED AND SHOULD NOT BE USED WITHOUT WRITTEN PERMISSION

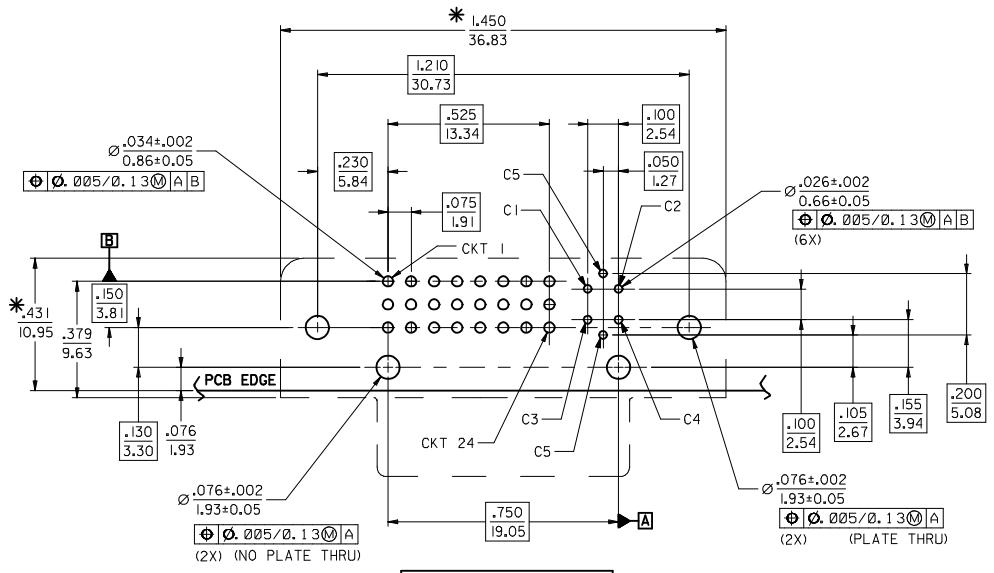

RECOMMENDED PCB LAYOUT

*THESE DIMENSIONS REPRESENT CONNECTOR OVERLAY ON PCB.

PLATING OPTIONS:

PLATING OPTION #1:

- OUTER SHIELD -- 150u"/(3.75um) MIN. BRIGHT TIN OVER
- 50u"/(1.27um) MIN. NICKEL OVER COPPER FLASH.
- .075"/(1.91mm) CONTACTS -- 30u"/(0.75um) MIN. SELECT GOLD AND 100u"/(2.50um) MIN. SELECT PURE TIN OVER 50u"/(1.27um) MIN. NICKEL OVERALL.
- .100"/(2.54mm) CONTACTS -- 30u"/(0.75um) MIN. SELECT GOLD AND 100u"/(2.50um) MIN. SELECT PURE TIN OVER 50u"/(1.27um) MIN. NICKEL OVERALL.

PLATING OPTION #2:

- OUTER SHIELD -- 150u"/(3.75um) MIN. BRIGHT TIN OVER
- 50u"/(1.27um) MIN. NICKEL OVER COPPER FLASH.
- .075"/(1.91mm) CONTACTS -- SELECT GOLD FLASH AND 100u"/(2.50um) MIN. SELECT PURE TIN OVER 50u"/(1.27um) MIN. NICKEL OVERALL.
- .100"/(2.54mm) CONTACTS -- SELECT GOLD FLASH AND 100u"/(2.50um) MIN. SELECT PURE TIN OVER 50u"/(1.27um) MIN. NICKEL OVERALL.

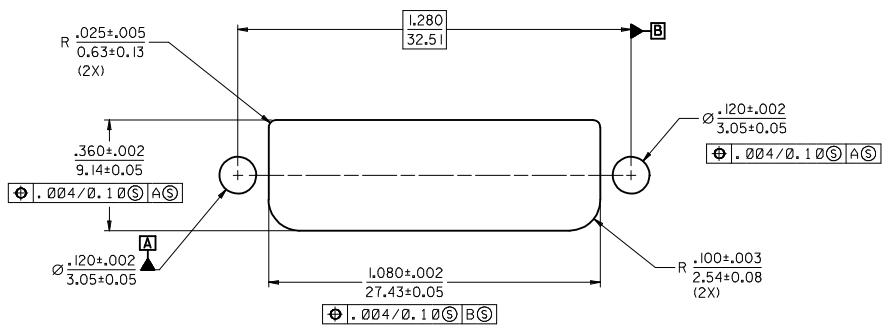

RECOMMENDED PANEL CUT-OUT
PANEL THICKNESS: .030" - .040"

SEE SHEET 1	DESCRIPTION
EC NO: SH2015-0200	2014/12/10
DRWN: XQZHANG	2014/12/10
CHKD: XQZHANG	2014/12/10
APPR: AYIN	2015/02/09
REV	

QUALITY SYMBOLS	DESCRIPTION
F _A =0	
F _C =0	
F _P =0	

GENERAL TOLERANCES (UNLESS SPECIFIED)	
mm	INCH
4 PLACES ± --- ± ---	
3 PLACES ± --- ± 0.10	
2 PLACES ± 0.25 ± 0.10	
1 PLACE ± 0.25 ± 0.10	
0 PLACE ± --- ± ---	
ANGULAR ±0.5°	
DRAFT WHERE APPLICABLE MUST REMAIN WITHIN DIMENSIONS	

DIMENSION STYLE	
IN/MM	
DRAWN BY	DATE
XQZHANG	2014/12/10
CHECKED BY	DATE
XQZHANG	2014/12/10
APPROVED BY	DATE
AYIN	2015/02/09
MATERIAL NO.	
SEE SHEET 1	
SIZE	
A3	

SCALE	DESIGN UNITS	THIRD ANGLE PROJECTION
1:1	INCH	
TITLE		
DVI - INTERGRATED RIGHT ANGLE RECEPTACLE CONNECTOR		
molex		
MATERIAL NO.	DOCUMENT NO.	SHEET NO.
SEE SHEET 1	SD-74320-001	2 OF 2
THIS DRAWING CONTAINS INFORMATION THAT IS PROPRIETARY TO MOLEX INCORPORATED AND SHOULD NOT BE USED WITHOUT WRITTEN PERMISSION		