

PART ILLUSTRATED IN THIS DRAWING IS 67600-8001

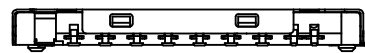
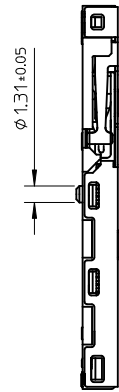
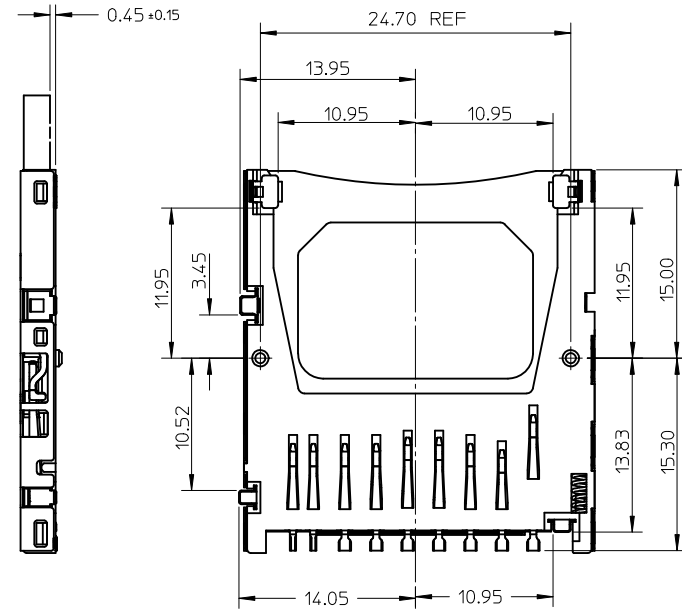
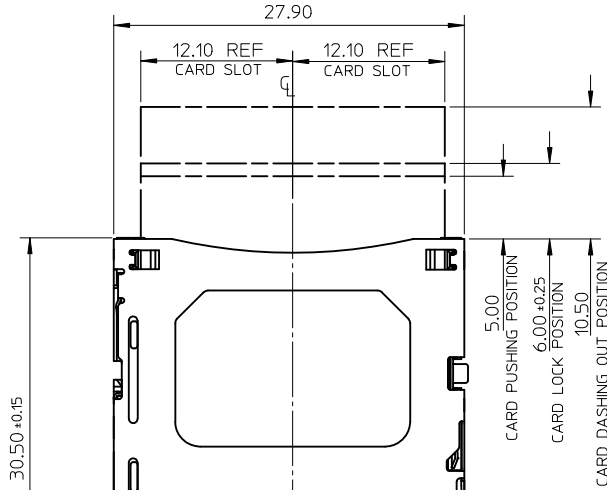
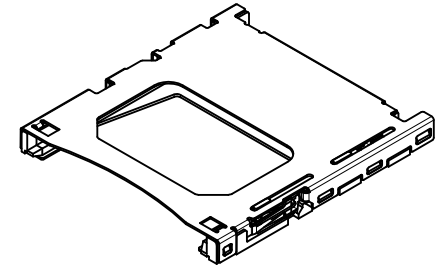
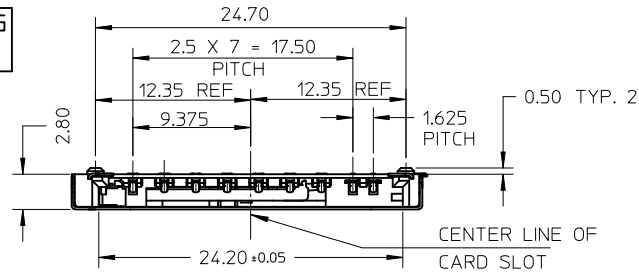

CARD CENTER

MATERIAL NO.	DESCRIPTION
67600-8001	STANDARD
67600-8005	W/O CARD LOCK PIN

REV	DESCRIPTION
G	UPDATE 1) VIEWS, 2) PART NUMBER TABLE 3) NOTE 9, 4) ADD NOTE 10

REVISED	EC NO: S2012-0634	DRWN: JESSIECHUA 2012/02/28	CHKD: CWANG25 2012/03/07	APPR: MAGESHKV 2012/03/07
DESCRIPTION				
QUALITY SYMBOLS	$\nabla = 0$ $\sphericalangle = 0$			

GENERAL TOLERANCES (UNLESS SPECIFIED)	<table border="1"> <thead> <tr> <th></th> <th>mm</th> <th>INCH</th> </tr> </thead> <tbody> <tr> <td>4 PLACES</td> <td>± ---</td> <td>± ---</td> </tr> <tr> <td>3 PLACES</td> <td>± ---</td> <td>± ---</td> </tr> <tr> <td>2 PLACES</td> <td>± 0.25</td> <td>± ---</td> </tr> <tr> <td>1 PLACE</td> <td>± 0.25</td> <td>± ---</td> </tr> </tbody> </table>			mm	INCH	4 PLACES	± ---	± ---	3 PLACES	± ---	± ---	2 PLACES	± 0.25	± ---	1 PLACE	± 0.25	± ---	DIMENSION STYLE MM ONLY	SCALE 1:1	DESIGN UNITS METRIC	THIRD ANGLE PROJECTION
	mm	INCH																			
4 PLACES	± ---	± ---																			
3 PLACES	± ---	± ---																			
2 PLACES	± 0.25	± ---																			
1 PLACE	± 0.25	± ---																			
ANGULAR ± 3 °	DRAFT WHERE APPLICABLE MUST REMAIN WITHIN DIMENSIONS		DRAWN BY DAVID HU	DATE 2004/12/20	TITLE SD MEMORY CARD CONN. ASS'Y (TOP MOUNT TYPE) LEAD-FREE																
			CHECKED BY HARVEY	DATE 2004/12/20	MOLEX INCORPORATED																
			APPROVED BY VINCENT	DATE 2004/12/20	DOCUMENT NO. SD-67600-006																
			MATERIAL NO. SEE TABLE	SHEET NO. 1 OF 2																	

SIZE A3	THIS DRAWING CONTAINS INFORMATION THAT IS PROPRIETARY TO MOLEX INCORPORATED AND SHOULD NOT BE USED WITHOUT WRITTEN PERMISSION				
------------	-------------------------------------------------------------------------------------------------------------------------------	--	--	--	--

NOTES:

- 1.MATERIAL:
 PLASTIC PART: HIGH TEMPERATURE THERMOPLASTIC.
 METAL PART: COPPER ALLOY OR STAINLESS STEEL.
- 2.TERMINAL AND NAIL COPLANARITY TO BE 0.1 MAX.
- 3.WHEN DELIVERING, THE PUSH/PUSH MECHANISM IS IN THE STATE OF THE UNLOCK.(CARD DASHING OUT POSITION).
- 4.CARD READ ONLY BY THE TIME THE CARD DETECTION SWITCH WORKS.
- 5.OPENING AND CLOSE OF EACH SWITCH.

CARD INSERTION STATUS	WRITE PROTECT SWITCH		CARD DETECT SWITCH
	WRITE PROTECT POSITION	WRITE ENABLE POSITION	
CARD UNINSERTION	OPEN	OPEN	OPEN
CARD HALF INSERTION	CLOSE	CLOSE	OPEN
CARD INSERTION	OPEN	CLOSE	CLOSE

- 6.TERMINAL PLATING:
 CONTACT AREA: GOLD, THICKNESS=0.2 MICRON MIN.
 SOLDER TAIL AREA(A): TIN, THICKNESS=1.27 MICRON MIN.
 (B): GOLD FLASH, THICKNESS=0.05 MICRON MIN.
 UNDER PLATE: NICKEL, THICKNESS=1 MICRON MIN.
- 7. PRODUCT SPECIFICATION : PER PS-67600-001.
- 8. TAPE AND REEL REFERS TO SD-67600-003 SHEET3.
- 9. N/A
- 10. DATE CODE: "YYMMDDA", "YY" REPRESENTS YEAR, "MM"REPRESENTS MONTH, "DD" REPRESENTS DAY; "A" REPRESENTS SHIFT.

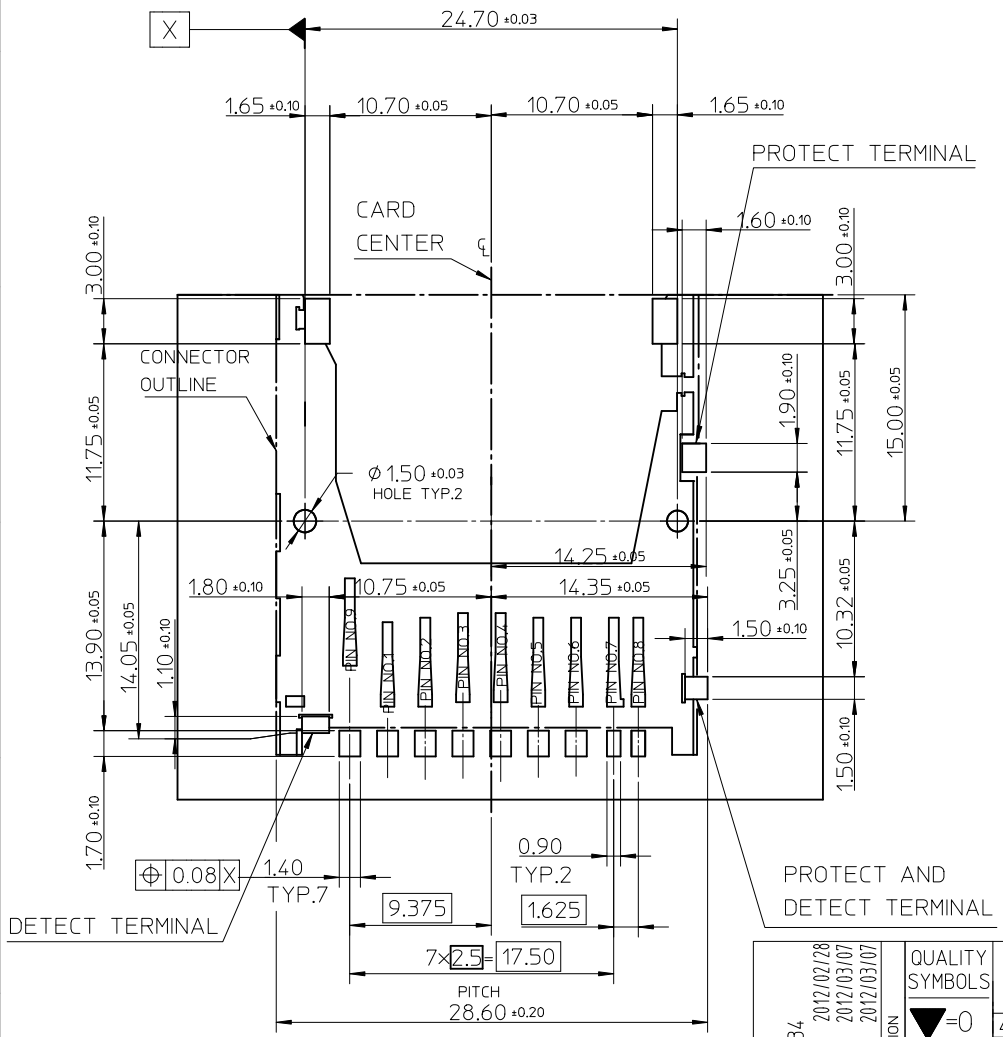

REVISED EC NO: S2012-0634 DRWN: JESSIECHUA 2012/02/28 CHKD: CWANG25 2012/03/07 APPR: MAGESHKN 2012/03/07	QUALITY SYMBOLS	▽=0 □=0
	DESCRIPTION	
	REV	

GENERAL TOLERANCES (UNLESS SPECIFIED)		DIMENSION STYLE MM ONLY		SCALE 1:1	DESIGN UNITS METRIC	THIRD ANGLE PROJECTION
	mm	INCH	DRAWN BY DAVID HU	DATE 2004/12/20	TITLE SD MEMORY CARD CONN. ASS'Y (TOP MOUNT TYPE) LEAD-FREE	
4 PLACES	± ---	± ---	CHECKED BY	DATE	MOLEX INCORPORATED	
3 PLACES	± ---	± ---	HARVEY	2004/12/20	DOCUMENT NO. SD-67600-006	
2 PLACES	± 0.25	± ---	APPROVED BY	DATE	SHEET NO. 2 OF 2	
1 PLACE	± 0.25	± ---	VINCENT	2004/12/20	THIS DRAWING CONTAINS INFORMATION THAT IS PROPRIETARY TO MOLEX INCORPORATED AND SHOULD NOT BE USED WITHOUT WRITTEN PERMISSION	
ANGULAR ± 3 °		MATERIAL NO. SEE TABLE				
DRAFT WHERE APPLICABLE MUST REMAIN WITHIN DIMENSIONS		SIZE A3				