

GREEN CODING
P/N 0988221035

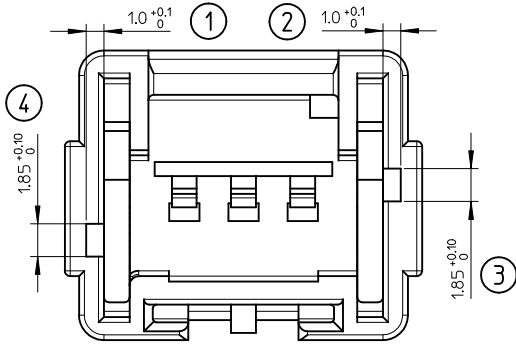

BLACK CODING
P/N 0988221031

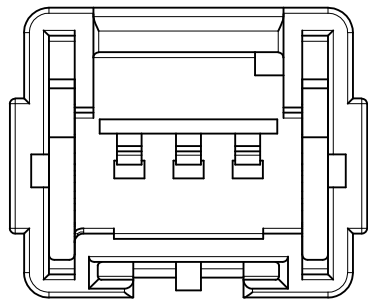

WHITE CODING
P/N 0988221030

CODING 5:1

HANDLING AREA

AREA REQUIRED TO MATE
AND UNMATE THE CONNECTOR

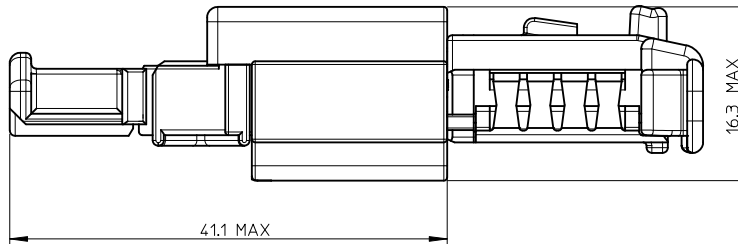
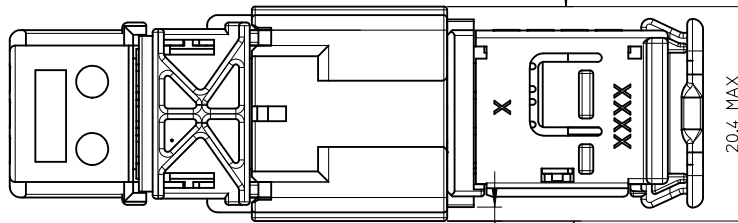

NOTE : 1 - The using conditions are shown in the MOLEX specification n°AS-98821-001.

2 - Male terminal used : SICMA 3 1.5mm

3 - Male connector will mate with female connector P/N 098817103x

AREA REQUIRED WHEN THE CONNECTOR IS MATED

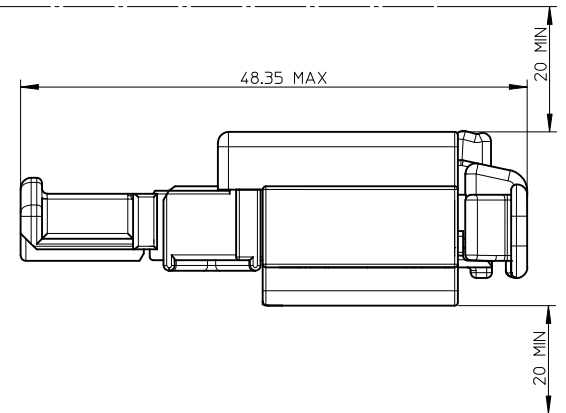

FIRST RELEASE EC NO: G2012-0106 DRAWN BY: VJOUAS 2012/01/18 CHKD: AHERBELIN 2012/01/18 APPR: OPLESSIS 2012/01/31	QUALITY SYMBOLS ▽=0 ▽=0 ▽=0	GENERAL TOLERANCES (UNLESS SPECIFIED)		DIMENSION STYLE MM ONLY	SCALE 3:1	DESIGN UNITS METRIC	FIRST ANGLE PROJECTION	
		4 PLACES ± --- ± ---	mm INCH	DRAWN BY VJOUAS	DATE 2012/01/18	TITLE NSCC PIN CONN 1.5 3CKT		
		3 PLACES ± --- ± ---		CHECKED BY AHERBELIN	DATE 2012/01/18	MOLEX INCORPORATED		
		2 PLACES ± --- ± ---		APPROVED BY OPLESSIS	DATE 2012/01/31	MATERIAL NO. SEE SHEET 2	DOCUMENT NO. SD-98822-003	SHEET NO. 1 OF 2
		1 PLACE ± 0.1 ± ---		THIS DRAWING CONTAINS INFORMATION THAT IS PROPRIETARY TO MOLEX INCORPORATED AND SHOULD NOT BE USED WITHOUT WRITTEN PERMISSION				
		ANGULAR ± 1 °						
		DRAFT WHERE APPLICABLE MUST REMAIN WITHIN DIMENSIONS						

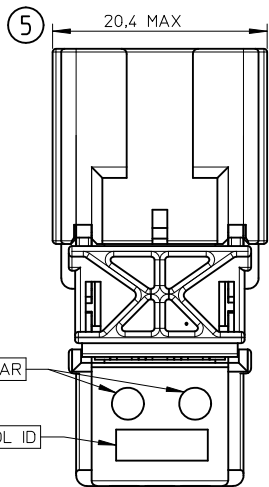

0988221035	GREEN
0988221031	BLACK
0988221030	WHITE
PART NUMBER ASSEMBLY PART	COLOR

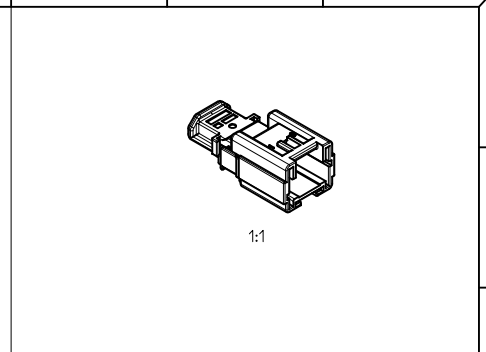

DATUM MONTH/YEAR

SUPPLIER ENGINEERING CONTROL ID

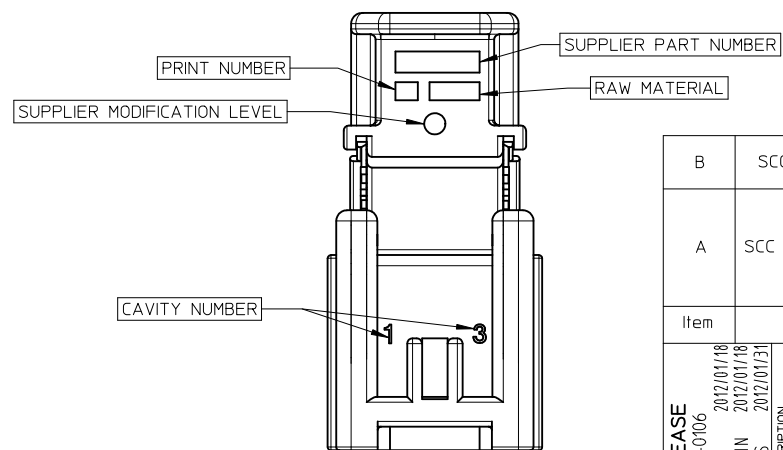
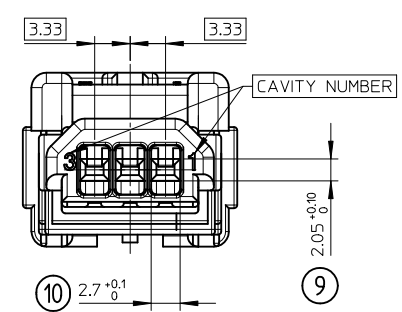
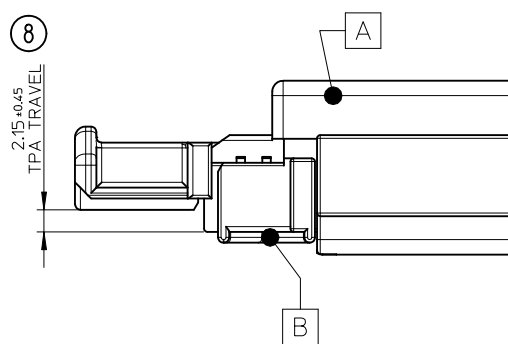
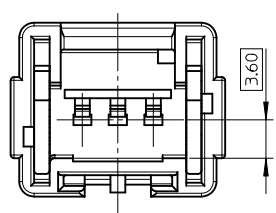
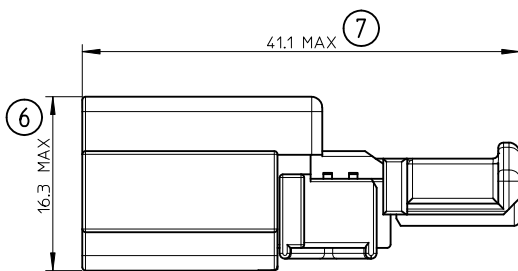

BLACK CODING (P/N 0988221031) IS SHOWN.

Item	Description	Part-number	Color	Raw Material	Weight effective (g)
B	SCC Pin Conn 1.5x0.8 TPA 3Ckt	0988220134	Yellow	POLYAMIDE >PA66-GF20<	4.94
A	SCC Pin Conn Unsealed 1.5x0.8 3Ckt	0988220035	Green	POLYESTER >PBT<	
		0988220031	Black		
		0988220030	White		

FIRST RELEASE EC NO: G2012-0106 DRAWN: VJOUAS 2012/01/18 CHKD: AHERBEL IN 2012/01/18 APPR: OPLESSIS 2012/01/31	DESCRIPTION VJOUAS AHERBEL IN OPLESSIS	QUALITY SYMBOLS	GENERAL TOLERANCES (UNLESS SPECIFIED)	DIMENSION STYLE	SCALE	DESIGN UNITS	FIRST ANGLE PROJECTION															
		$\nabla=0$ $\nabla=0$ $\nabla=0$	<table border="1"> <tr> <th></th> <th>mm</th> <th>INCH</th> </tr> <tr> <td>4 PLACES</td> <td>± ---</td> <td>± ---</td> </tr> <tr> <td>3 PLACES</td> <td>± ---</td> <td>± ---</td> </tr> <tr> <td>2 PLACES</td> <td>± ---</td> <td>± ---</td> </tr> <tr> <td>1 PLACE</td> <td>± 0.1</td> <td>± ---</td> </tr> </table>		mm	INCH	4 PLACES	± ---	± ---	3 PLACES	± ---	± ---	2 PLACES	± ---	± ---	1 PLACE	± 0.1	± ---	MM ONLY DRAWN BY: VJOUAS DATE: 2012/01/18 CHECKED BY: AHERBEL IN DATE: 2012/01/18 APPROVED BY: OPLESSIS DATE: 2012/01/31	3:1	METRIC	
			mm	INCH																		
		4 PLACES	± ---	± ---																		
3 PLACES	± ---	± ---																				
2 PLACES	± ---	± ---																				
1 PLACE	± 0.1	± ---																				
DRAFT WHERE APPLICABLE MUST REMAIN WITHIN DIMENSIONS		SEE CHART	TITLE: NSCC PIN CONN 1.5 3CKT MATERIAL NO. SD-98822-003 DOCUMENT NO.	MOLEX INCORPORATED		SHEET NO. 2 OF 2																
SIZE A 2 THIS DRAWING CONTAINS INFORMATION THAT IS PROPRIETARY TO MOLEX INCORPORATED AND SHOULD NOT BE USED WITHOUT WRITTEN PERMISSION																						