

PART NUMBER	DIM 'A'	DIM 'B'	BLADE TYPE	PLATING	PEGS
75556-5000	0.00/.000	3.06/1.120	LONG	30μ INCH MIN SELECT HARD GOLD IN CONTACT AREA WITH 100μ INCH MIN SELECT TIN IN TAIL AREA OVER 50μ INCH MIN NICKEL OVERALL.	W/O PEGS
75556-5001	0.00/.000	3.81/1.150	LONG		
75556-5100	1.50/.059	3.06/1.120	SHORT		
75556-5101	1.50/.059	3.81/1.150	SHORT		
75556-1500	0.00/.000	3.06/1.120	LONG	30μ INCH MIN SELECT HARD GOLD IN CONTACT AREA WITH 100μ INCH MIN SELECT TIN IN TAIL AREA OVER 50μ INCH MIN NICKEL OVERALL.	W/PEGS
75556-1501	0.00/.000	3.81/1.150	LONG		
75556-1510	1.50/.059	3.06/1.120	SHORT		
75556-1511	1.50/.059	3.81/1.150	SHORT		

(A6)

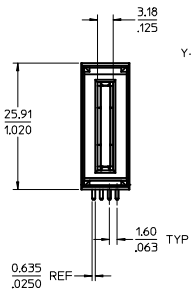

75556-5*** SHOWN (W/O PEG)

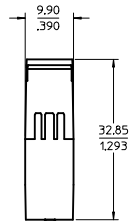
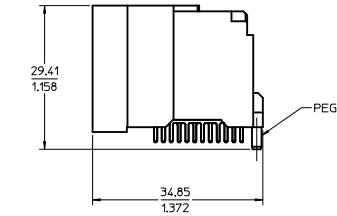
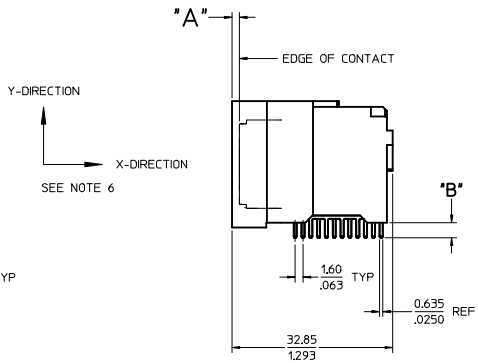

75556-15** SHOWN (W/PEG)

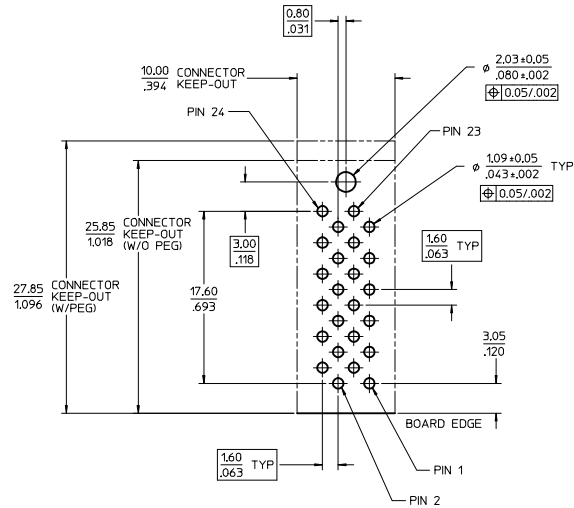

PCB LAYOUT SCALE: 4:1

- NOTES:
1. MATERIALS:
- HOUSING: 30% GLASS FILLED, LCP 94V-0, COLOR BLACK
- TERMINALS: COPPER ALLOY
- PLATING: PER ES-88 - SEE CHART
 2. SEE CHART FOR REFERENCE DOCUMENTS
 3. PLUG MATES WITH RECEPTACLE ASSEMBLIES: 75542-5000 & 75542-5001
 4. MODULE IS DESIGNED FOR SOLDERING TO THE PCB
 5. MODULE ASSEMBLY IS RoHS COMPLIANT
 6. GATHERABILITY: ±0.65/.026 X-DIRECTION
±1.30/.051 Y-DIRECTION

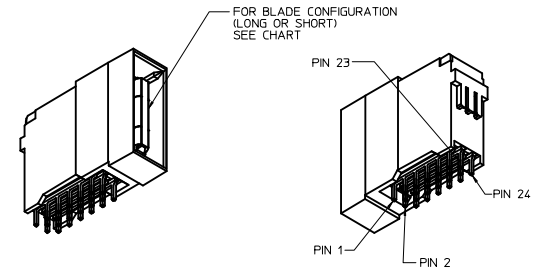

75556-5100 SHOWN (W/O PEG)

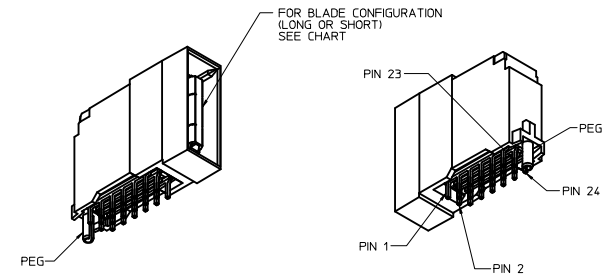

75556-1500 SHOWN (W/PEG)

REFERENCE DOCUMENTS	
PS-75431-999	PRODUCT SPECIFICATION: PERFORMANCE AND RATINGS
SD-75555-***	FINAL ASSEMBLY CONFIGURATION DRAWING

REVISED CHART IEC NO: UCP2015-1065 DRAWN: DUILLES 2014/09/11 CHK: BHANDHARA 2014/09/11 APPR: APATEL 2014/09/16 A6	QUALITY SYMBOLS ∇=0 ∇=0 ∇=0	GENERAL TOLERANCES (UNLESS SPECIFIED): <table border="1"> <tr> <th>mm</th> <th>INCH</th> </tr> <tr> <td>4 PLACES ±---</td> <td>±---</td> </tr> <tr> <td>3 PLACES ±---</td> <td>±.008</td> </tr> <tr> <td>2 PLACES ±0.20</td> <td>±.015</td> </tr> <tr> <td>1 PLACE ±0.33</td> <td>±---</td> </tr> </table> ANGULAR ±1/2° DRAFT WHERE APPLICABLE MUST REMAIN WITHIN DIMENSIONS	mm	INCH	4 PLACES ±---	±---	3 PLACES ±---	±.008	2 PLACES ±0.20	±.015	1 PLACE ±0.33	±---	DIMENSION STYLE MM/IN DRAWN BY: ADRA TNOL DATE: 2005/04/19 CHECKED BY: MDATA DATE: 2005/04/19 APPROVED BY: APATEL DATE: 2005/04/19	SCALE 2:1 DESIGN UNITS METRIC THIRD ANGLE PROJECTION	TITLE EXTREME POWERMASS 150 AMP MODULE, PLUG MATERIAL NO. SEE CHART DOCUMENT NO. SD-75556-100	SHEET NO. 1 OF 1
	mm	INCH														
	4 PLACES ±---	±---														
3 PLACES ±---	±.008															
2 PLACES ±0.20	±.015															
1 PLACE ±0.33	±---															
MOLEX INCORPORATED																
THIS DRAWING CONTAINS INFORMATION THAT IS PROPRIETARY TO MOLEX INCORPORATED AND SHOULD NOT BE USED WITHOUT WRITTEN PERMISSION																