

MATERIAL NO.	KEY OPTION	TAIL PLATING
76105-0184	LEFT	TIN / LEAD
76105-0185	LEFT	TIN

OBSELETE

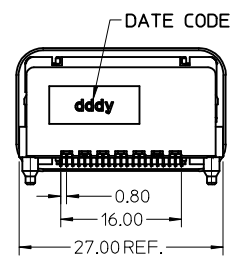
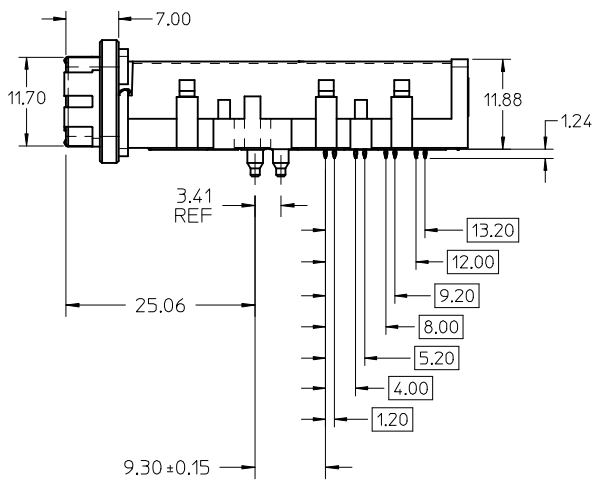
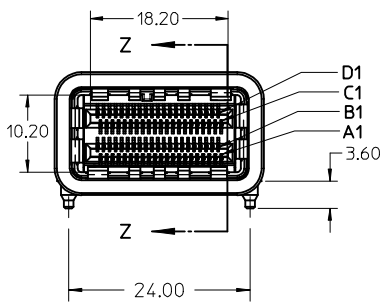
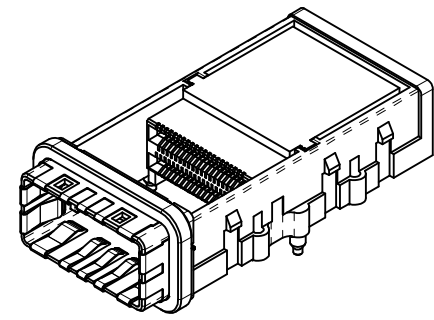
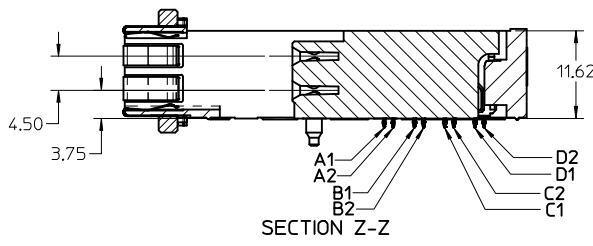
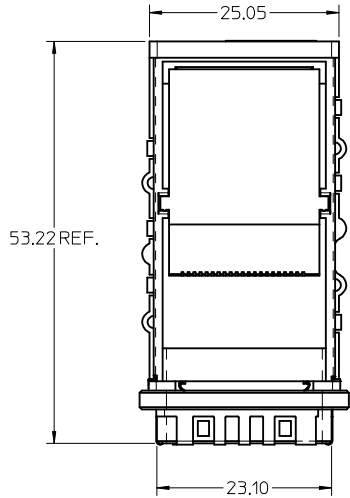

- NOTES:
- MATERIALS:**
CONNECTOR HOUSING: HIGH TEMPERATURE THERMOPLASTIC
GLASS-FILLED, UL 94V-0
EMI HOUSING: NICKEL PLATED DIE CAST ALLOY
EMI GASKET: CONDUCTIVE POLYMER
TERMINALS: COPPER ALLOY
 - PLATING:**
CONTACT AREA: 0.76µm MIN. GOLD OVER 2.54µm MIN. NICKEL
TIN/LEAD TAIL AREA: 0.76µm - 1.52µm TIN/LEAD (90/10)
TIN TAIL AREA: 0.76µm - 1.52µm TIN
OVER 1.27µm MIN NICKEL
 - PACKAGING SPECIFICATION:** TRAY PACK PER PK-76105-001.
 - MOUNTING HARDWARE REQUIRED:** M2x0.4 CAP SCREWS (4)
MOUNTING SCREW LENGTH: BOARD THICKNESS + 4mm MAX

REVISIONS REV DESCRIPTION 1 2 3 4	QUALITY SYMBOLS ▽=0 ▽=0	GENERAL TOLERANCES (UNLESS SPECIFIED) mm INCH 4 PLACES ± --- ± --- 3 PLACES ± --- ± --- 2 PLACES ± 0.25 ± --- 1 PLACE ± --- ± --- ANGULAR ± 1/2°	DIMENSION STYLE MM ONLY DRAWN BY DATE JLONG 2009/10/13 CHECKED BY DATE JLONG 2009/10/13 APPROVED BY DATE	SCALE 2:1 DESIGN UNITS METRIC THIRD ANGLE PROJECTION	TITLE IPASS PLUS HSC 84 HIGH SPEED CHANNEL 0.8MM I/O	MATERIAL NO. SEE CHART	DOCUMENT NO. SD-76105-184	SHEET NO. 1 OF 4
	DRAFT WHERE APPLICABLE MUST REMAIN WITHIN DIMENSIONS		MATERIAL NO. DOCUMENT NO. SHEET NO. SEE CHART SD-76105-184 1 OF 4			THIS DRAWING CONTAINS INFORMATION THAT IS PROPRIETARY TO MOLEX INCORPORATED AND SHOULD NOT BE USED WITHOUT WRITTEN PERMISSION		

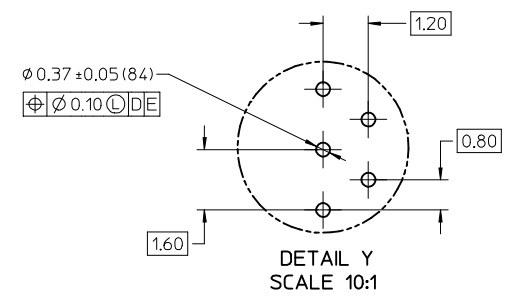
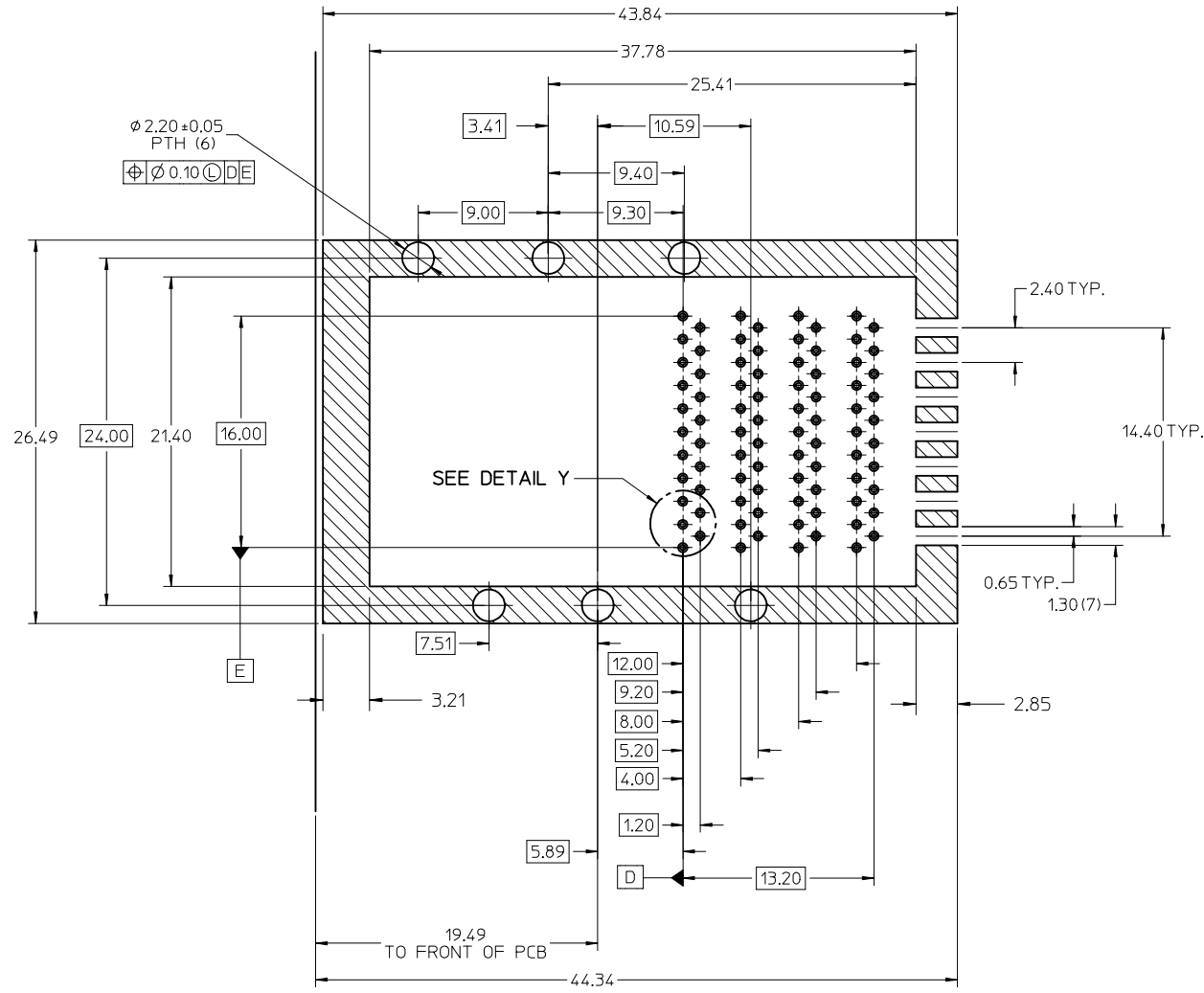

- NOTES:
- CROSS-HATCHED AREA TO BE CONDUCTIVE ON THE PCB.
 - CROSS-HATCHED AREA MUST BE INCORPORATED IN THE FLAT ROCK PRESS-FIT TOOLING.
 - RECOMMENDED DRILL SIZE FOR 0.37 ϕ FINISHED PTH IS 0.48-0.50 mm ϕ (.0189-.0200 in ϕ (#76 DRILL))
 - RECOMMENDED ANNULAR RING AROUND 0.37 ϕ FINISHED PTH IS 0.73 ϕ
 - MINIMUM RECOMMENDED SPACING: 26.50

RECOMMENDED PCB LAYOUT
COMPONENT SIDE SHOWN
PCB THICKNESS: 1.57mm MIN.

SEE SHEET 1 EC NO: UCP2013-0647 DRAWING PRATT 2012/08/28 CHKD: MBANAKIS 2012/08/28 APPR: MBANAKIS 2012/08/30	QUALITY SYMBOLS	GENERAL TOLERANCES (UNLESS SPECIFIED)	DIMENSION STYLE		SCALE	DESIGN UNITS	THIRD ANGLE PROJECTION
	$\nabla=0$		mm	INCH	4:1	METRIC	
	$\nabla=0$		DRAWN BY DATE		TITLE		
			JLONG 2009/10/13		IPASS PLUS HSC 84 HIGH SPEED CHANNEL 0.8MM I/O		
		4 PLACES \pm --- \pm ---	CHECKED BY DATE	MOLEX INCORPORATED			
		3 PLACES \pm --- \pm ---	JLONG 2009/10/13	DOCUMENT NO.			SHEET NO.
		2 PLACES ± 0.25 \pm ---	APPROVED BY DATE	SEE CHART			2 OF 4
		1 PLACE \pm --- \pm ---		MATERIAL NO.			
		ANGULAR $\pm 1/2^\circ$		SD-76105-184			
				DRAFT WHERE APPLICABLE MUST REMAIN WITHIN DIMENSIONS			

DRAFT WHERE APPLICABLE
MUST REMAIN
WITHIN DIMENSIONS

GENERAL TOLERANCES (UNLESS SPECIFIED)		DIMENSION STYLE	SCALE	DESIGN UNITS	THIRD ANGLE PROJECTION
		MM ONLY	4:1	METRIC	
		DRAWN BY DATE	TITLE		
		JLONG 2009/10/13	IPASS PLUS HSC 84 HIGH SPEED CHANNEL 0.8MM I/O		
		CHECKED BY DATE	MOLEX INCORPORATED		
		JLONG 2009/10/13	DOCUMENT NO.		SHEET NO.
		APPROVED BY DATE	SEE CHART		2 OF 4
			MATERIAL NO.		
			SD-76105-184		
			DRAFT WHERE APPLICABLE MUST REMAIN WITHIN DIMENSIONS		

THIS DRAWING CONTAINS INFORMATION THAT IS PROPRIETARY TO MOLEX INCORPORATED AND SHOULD NOT BE USED WITHOUT WRITTEN PERMISSION

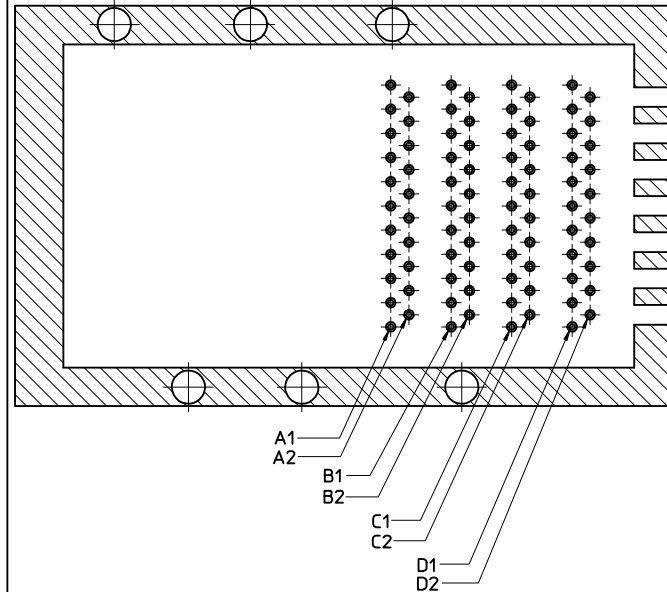
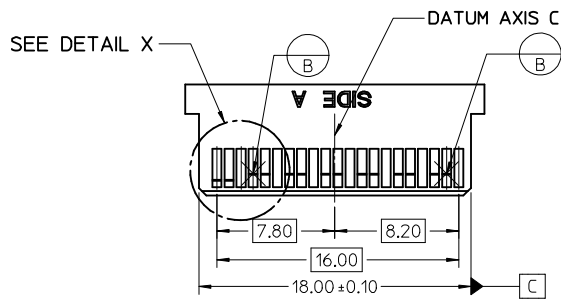
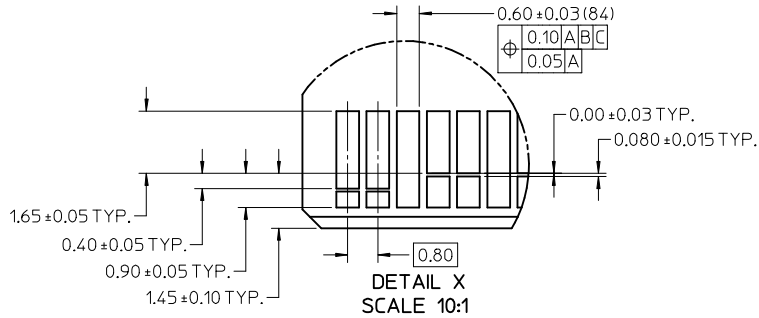
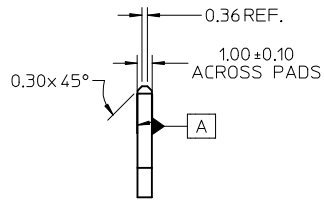
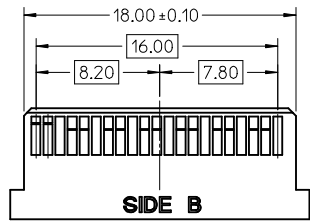

NOTES:

- 0.03 MINIMUM KEEP OUT FOR SOLDER MASK AROUND ALL PADS
- DATUM B TARGETS ARE DEFINED BY THE RESPECTIVE PAD CENTER LINES AND THE LEADING EDGE OF THE TARGET PADS

SEE SHEET 1 EC NO: UCP2013-0617 DRAWING: GRATT 2012/08/28 CHKD: MBANAKIS 2012/08/28 APPR: MBANAKIS 2012/08/30	QUALITY SYMBOLS ▽=0 ▽=0	GENERAL TOLERANCES (UNLESS SPECIFIED)		DIMENSION STYLE MM ONLY	SCALE 4:1	DESIGN UNITS METRIC	THIRD ANGLE PROJECTION		
		4 PLACES ± --- ± ---	3 PLACES ± --- ± ---	2 PLACES ± 0.25 ± ---	1 PLACE ± --- ± ---	DRAWN BY JLONG	DATE 2009/10/13	TITLE IPASS PLUS HSC 84 HIGH SPEED CHANNEL 0.8MM I/O	
		ANGULAR ± 1/2°				CHECKED BY JLONG	DATE 2009/10/13	MOLEX INCORPORATED	
		DRAFT WHERE APPLICABLE MUST REMAIN WITHIN DIMENSIONS				APPROVED BY	DATE	MATERIAL NO. SEE CHART	DOCUMENT NO. SD-76105-184

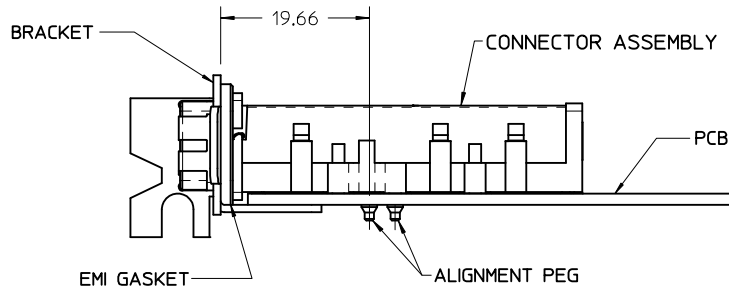
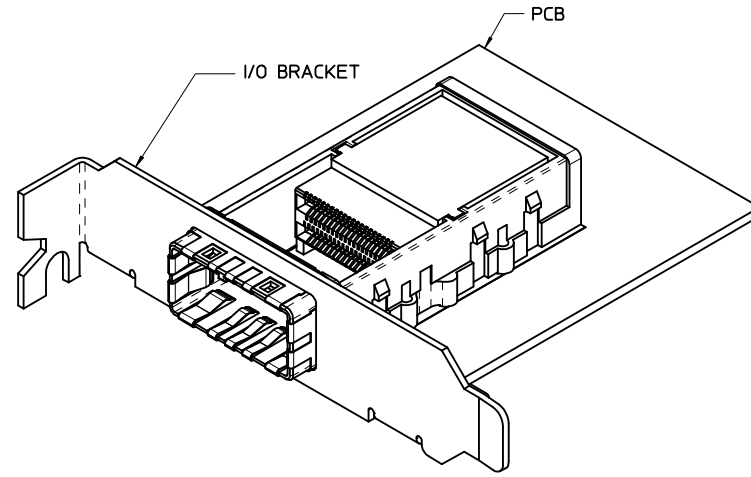

ASSEMBLED VIEW

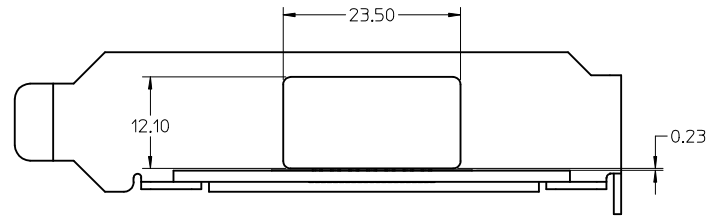

I/O BRACKET CUT-OUT

(NOT SUPPLIED)

SEE SHEET 1 EC NO: UCP2013-0617 DRAWING: GPRATT 2012/08/28 CHKD: MBANAKI S 2012/08/28 APPR: MBANAKI S 2012/08/30	QUALITY SYMBOLS ▽=0 ▽=0	GENERAL TOLERANCES (UNLESS SPECIFIED)		DIMENSION STYLE MM ONLY	SCALE 2:1	DESIGN UNITS METRIC	THIRD ANGLE PROJECTION		
		4 PLACES ± --- ± --- 3 PLACES ± --- ± --- 2 PLACES ± 0.25 ± --- 1 PLACE ± --- ± ---	mm INCH	DRAWN BY DATE JLONG 2009/10/13	CHECKED BY DATE JLONG 2009/10/13	TITLE IPASS PLUS HSC 84 HIGH SPEED CHANNEL 0.8MM I/O			
		ANGULAR ±1/2°		APPROVED BY DATE	MOLEX INCORPORATED				
		DRAFT WHERE APPLICABLE MUST REMAIN WITHIN DIMENSIONS		MATERIAL NO. SEE CHART	DOCUMENT NO. SD-76105-184	SHEET NO. 4 OF 4			