

LENGTH TABLE			-A-		-B-	
CIRCUITS	MATERIAL NO.	ENG. NO.	INCH	mm	INCH	mm
02	394250002	421902	1.11	28.2	.472	12.0
03	394250003	421903	1.58	40.1	.945	24.0
04	394250004	421904	2.06	52.3	1.417	36.0
05	394250005	421905	2.53	64.3	1.890	48.0
06	394250006	421906	3.00	76.2	2.362	60.0
07	394250007	421907	3.47	88.1	2.835	72.0
08	394250008	421908	3.95	100.3	3.307	84.0
09	394250009	421909	4.42	112.3	3.780	96.0
10	394250010	421910	4.89	124.2	4.252	108.0

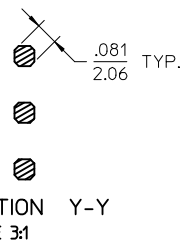
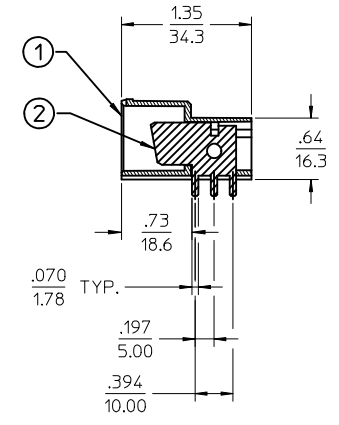
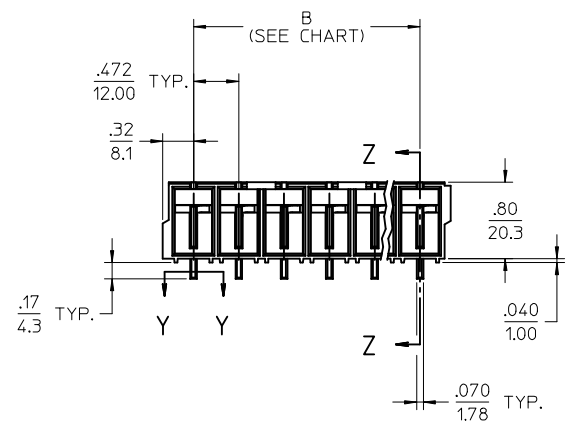
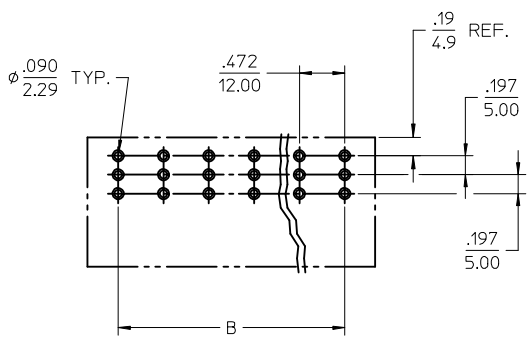
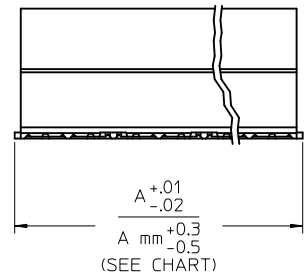
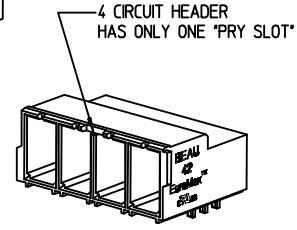
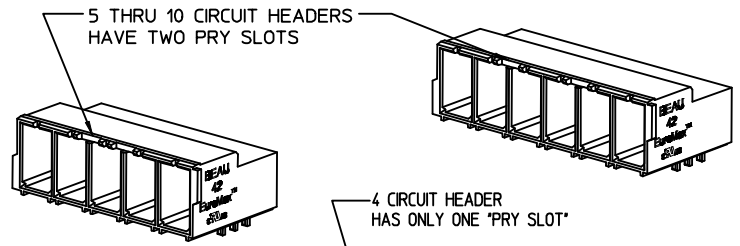
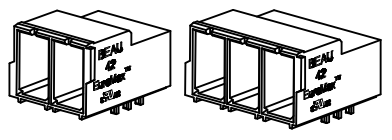

- NOTES:
1. MATERIAL: SEE TABLE
 2. FINISHES: SEE TABLE
 3. ELECTRICAL SPECIFICATIONS:
VOLTAGE: 600VAC
CURRENT: 85 AMPS (3AWG WIRE)
 4. MATES WITH: 3942100XX PLUG
 5. XX EQUALS NUMBER OF CIRCUITS

2	XX	BLADE CONTACT	COPPER	TIN
1	1	MOLDING, HEADER	NYLON $\text{\textcircled{G}}$	BLACK
ITEM	QTY.	DESCRIPTION	MATERIAL	FINISH

MAT. WAS PBT. REV. TOL. BLOCK EC NO: JFG2015-1263 DRAWNRSTONE 2015/01/14 CHKD: B ARDEN 2015/01/15 APPR: BWOODMAN 2015/01/14 DESCRIPTION	QUALITY SYMBOLS	GENERAL TOLERANCES (UNLESS SPECIFIED) <table border="1"> <thead> <tr> <th></th> <th>mm</th> <th>INCH</th> </tr> </thead> <tbody> <tr><td>4 PLACES</td><td>\pm ---</td><td>\pm ---</td></tr> <tr><td>3 PLACES</td><td>\pm ---</td><td>\pm .005</td></tr> <tr><td>2 PLACES</td><td>\pm 0.13</td><td>\pm .01</td></tr> <tr><td>1 PLACE</td><td>\pm 0.3</td><td>\pm ---</td></tr> <tr><td>0 PLACE</td><td>\pm ---</td><td>\pm ---</td></tr> </tbody> </table>		mm	INCH	4 PLACES	\pm ---	\pm ---	3 PLACES	\pm ---	\pm .005	2 PLACES	\pm 0.13	\pm .01	1 PLACE	\pm 0.3	\pm ---	0 PLACE	\pm ---	\pm ---	DIMENSION STYLE	SCALE	DESIGN UNITS	THIRD ANGLE PROJECTION
			mm	INCH																				
	4 PLACES		\pm ---	\pm ---																				
	3 PLACES		\pm ---	\pm .005																				
	2 PLACES		\pm 0.13	\pm .01																				
1 PLACE	\pm 0.3	\pm ---																						
0 PLACE	\pm ---	\pm ---																						
	IN/MM	1:1	INCH																					
	DRAWN BY	DATE	TITLE																					
	RSTONE	2014/12/12	HEADER ASSEMBLY 12MM , 85A, 600V																					
	CHECKED BY	DATE																						
	B ARDEN	2014/12/19																						
	APPROVED BY	DATE																						
	BWOODMAN	2014/12/19																						
	MATERIAL NO.	DOCUMENT NO.																						
	SEE CHART	SD-39425-001																						
	SIZE		SHEET NO.																					
	C		1 OF 1																					
	DRAFT WHERE APPLICABLE MUST REMAIN WITHIN DIMENSIONS THIS DRAWING CONTAINS INFORMATION THAT IS PROPRIETARY TO MOLEX INCORPORATED AND SHOULD NOT BE USED WITHOUT WRITTEN PERMISSION																							