

NOTES:

1. MATERIAL:

CAGE: NICKEL SILVER, 0.25 THICK
EMI STRAPS: PHOS-BRONZE, 0.10 THICK
LIGHT PIPES: POLYCARBONATE, 94V-0 (OPTIONAL)
CONNECTOR HOUSING: HIGH PERFORMANCE THERMOPLASTIC, 94V-0
TERMINALS: HIGH PERFORMANCE COPPER ALLOY, 0.18 THICK

2. FINISH:

SPRING FINGERS: 100µm NICKEL OVERALL
TERMINALS: CONTACT AREA: 0.76µm MIN GOLD OVER
2.5µm MIN NICKEL.

COMPLIANT AREA: 0.76-1.52µm MATTE TIN
OVER 1.27µm MIN NICKEL.

3. ALL SURFACES TO BE CLASS 'C' OR BETTER PER MOLEX COSMETIC SPECIFICATION PS-45499-002.

4. REFER TO PK-76871-9001 FOR ALL PACKAGING SPECIFICATIONS.

5. CONNECTOR INTENDED TO MATE WITH PLUG CABLE SERIES 74757 AND 74758.

6. DATE CODE LOCATION SHOWN, DATE CODE FORMAT: DDDY

DDD = DAY OF THE YEAR, Y = YEAR.

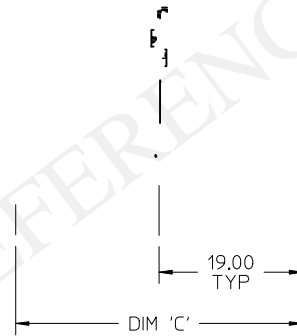

| PORT SIZE | PART NUMBER | DIM A | DIM B | DIM C |
|-----------|-------------|-------|-------|-------|
| 2X1 | 171565-1005 | 19.3 | 21.4 | 19.0 |
| 2X2 | 171565-0005 | 38.3 | 40.4 | 38.0 |
| 2X3 | 171565-3005 | 57.3 | 59.4 | 57.0 |