

LCS Series Subminiature Sealed Snap-acting Switches



UL61058-1



Features/Benefits

- Compact design
- Long life and high electrical capacity
- Quick connect, solder terminals, PC terminals, wire leads
- Wide variety of actuator styles
- RoHS compatible, RoHS compliant
- IP67

Typical Applications

- Motorized equipment
- Sump pump
- Thermostatic controls
- Computers
- Air conditioners

Specifications

CONTACT RATING: from low level to 5 Amp
 ELECTRICAL LIFE: 10,000 cycles
 INSULATION RESISTANCE: 100 M ohm min.
 DIELECTRIC STRENGTH: 1,000 VAC
 OPERATING TEMPERATURE:
 -40°C to +120°C (without wire)
 -40°C to +85°C (with UL1007 wire)
 -40°C to +105°C (with UL1015 wire)
 -40°C to +105°C (with UL1430 wire)
 -40°C to +80°C (with UL1061 wire)
 -40°C to +120°C (with UL1330 wire)
 OPERATING FORCE: (see ACTUATOR'S option sections).
 MOUNTING: 2-56 screws, torque 2.3 in/lbs max.

Materials

SWITCH HOUSING: Thermoplastic polyester or high temperature thermoplastic (PTS) (UL 94V-0).
 ACTUATOR BUTTON: Thermoplastic polyester.
 SPRING: Copper alloy.
 PIVOT: Copper alloy.
 MOVABLE CONTACTS: Option "01" Gold plating over silver alloy
 Option "05" Silver alloy
 STATIONARY CONTACTS: Option "01" Gold plating over silver alloy
 Option "05" Silver alloy
 TERMINALS: Copper alloy.
 ACTUATOR LEVEL: Stainless steel.

NOTE: Specifications and materials listed above are for switches with standard options.
 For information on specific and custom switches, consult Customer Service center.

Snap-acting

Build-A-Switch

To order, simply select desired option from each category and place in the appropriate box. Available options are shown and described on pages J-40 thru J-43. For additional options not shown in catalog, consult Customer Service Center.

<div style="display: flex; align-items: center;"> <div style="margin-right: 10px;">Series</div> <div style="border: 1px solid black; padding: 2px;">L</div> <div style="border: 1px solid black; padding: 2px;">C</div> <div style="border: 1px solid black; padding: 2px;">S</div> <div style="border: 1px solid black; width: 20px; height: 15px; margin-left: 5px;"></div> <div style="border: 1px solid black; width: 20px; height: 15px; margin-left: 5px;"></div> <div style="border: 1px solid black; width: 20px; height: 15px; margin-left: 5px;"></div> <div style="border: 1px solid black; width: 20px; height: 15px; margin-left: 5px;"></div> <div style="border: 1px solid black; width: 20px; height: 15px; margin-left: 5px;"></div> <div style="border: 1px solid black; width: 20px; height: 15px; margin-left: 5px;"></div> <div style="border: 1px solid black; width: 20px; height: 15px; margin-left: 5px;"></div> <div style="border: 1px solid black; width: 20px; height: 15px; margin-left: 5px;"></div> <div style="border: 1px solid black; width: 20px; height: 15px; margin-left: 5px;"></div> <div style="border: 1px solid black; width: 20px; height: 15px; margin-left: 5px;"></div> <div style="border: 1px solid black; width: 20px; height: 15px; margin-left: 5px;"></div> </div>		
<div style="display: flex; align-items: center;"> <div style="margin-right: 10px;">Electrical Rating</div> <div style="border: 1px solid black; padding: 2px;">2</div> </div>		
Option Code	UL 61058-1	
01	0.1 A 125/250 V AC	NA
05	5 A 125/250 V AC	6 A 250 V AC

Operating Force
 2 203 grams

Actuator
 P00 Pin plunger
 T00 11.9 mm short lever
 T05 17.4 mm short lever
 T07 19.4 mm short lever
 T13 25.5 mm lever
 T19 33.3 mm lever
 T28 40.7 mm lever
 T43 55.9 mm lever
 S26 18.6 mm simulated lever
 A05 17.2 mm lever roller

Terminations
 S Solder
 Q 0.110 Quick Connect
 P PC Thru Hole
 W Wire leads potted
 Z Wire leads non-potted

Wire Type AWG
 20 20 AWG
 22 22 AWG
 24 24 AWG
 26 26 AWG

Wire UL # (when required)
 A UL1007
 B UL1015
 C UL1430
 D UL1061

Circuitry
 C SPDT
 W SPST N.C.
 Y SPST N.O.

Wire Side (when required)
 A Wire out the bottom
 B Wire out the right side
 C Wire out the left side
 D None



Dimensions are shown: mm
 Specifications and dimensions subject to change

LCS Series

Subminiature Sealed Snap-acting Switches

SERIES

LCS

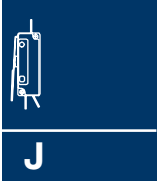
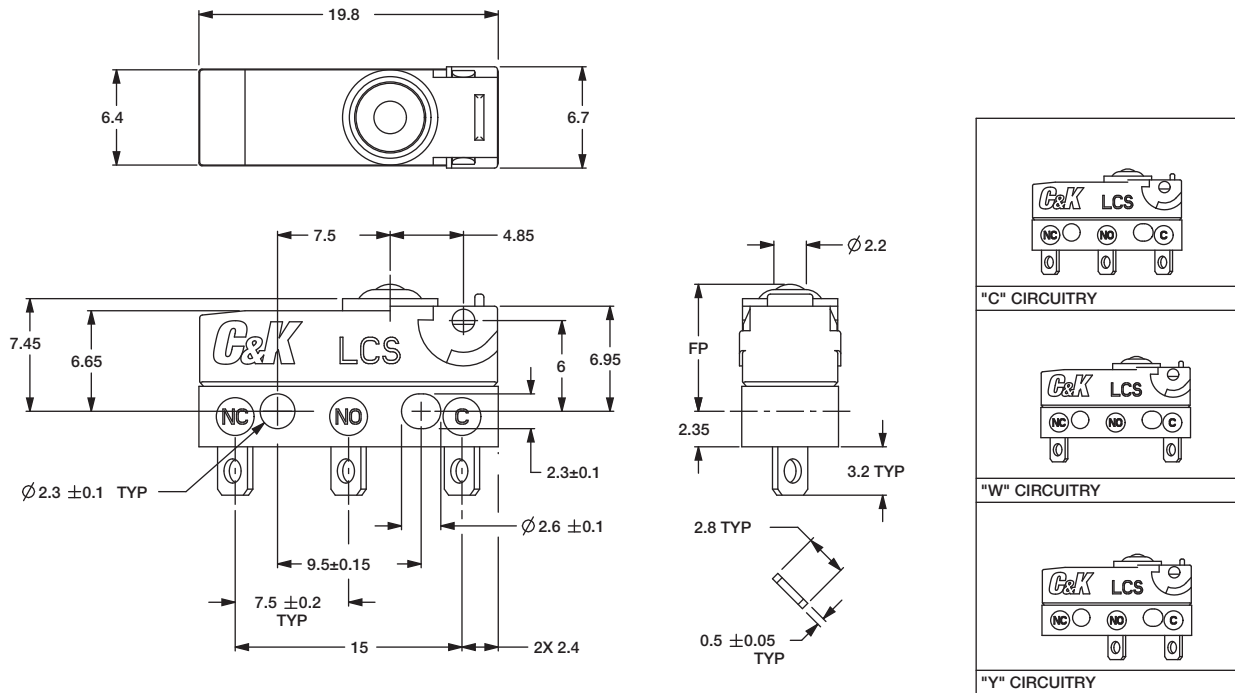

Snap-acting

ELECTRICAL RATING

RoHS COMPLIANT *	RoHS COMPATIBLE *	OPTION CODE	ELECTRICAL RATING
YES	YES	05	5 AMP, 125/250 V AC
YES	YES	01	0.1 AMP, 125/250 V AC

OPERATING FORCE

OPTION CODE	OPERATING FORCES (grams)
2	203 g. max.

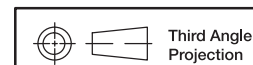

*Dimensions are shown: mm
Specifications and dimensions subject to change*

LCS Series Subminiature Sealed Snap-acting Switches

ACTUATOR 

P00

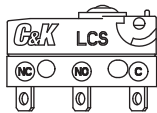

T19

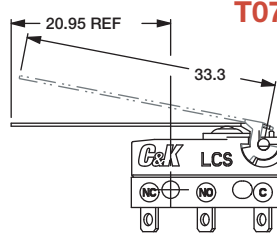

T07

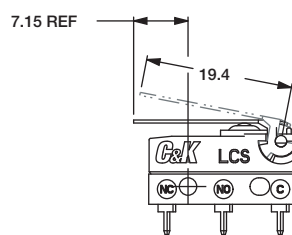

A05

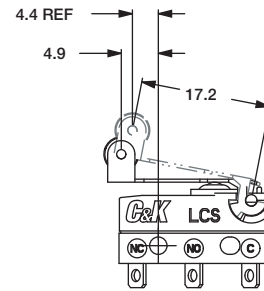

T00

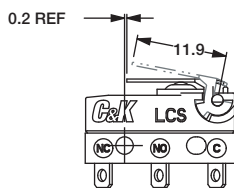

T28

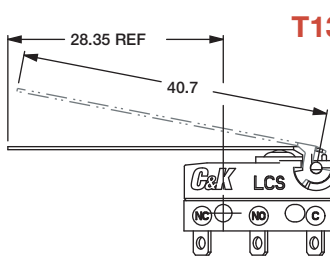

T13

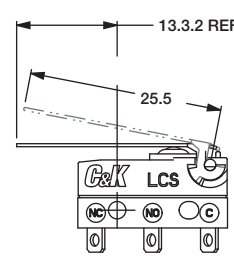

S26

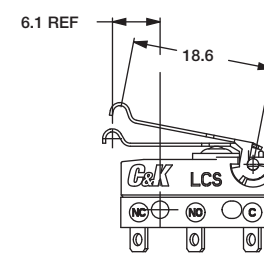

T05

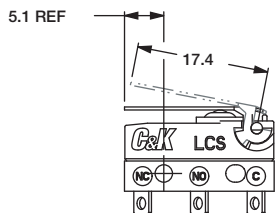

T43

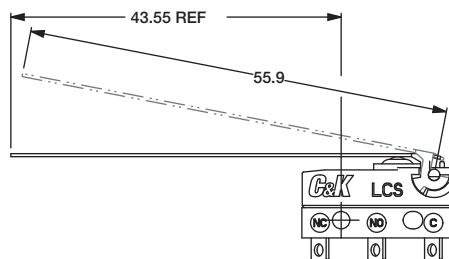

Snap-acting

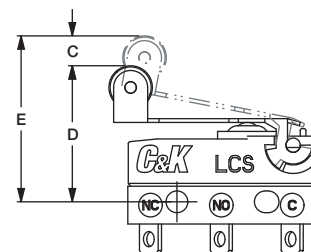
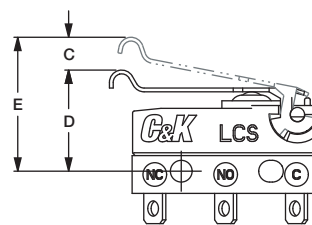
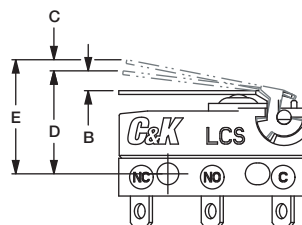
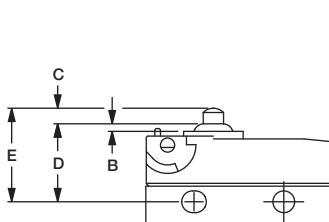

ACTUATOR OPTION CODE	A	B	C	D	E	DIFFERENTIAL MOTION (MAX)	OPERATING FORCE (MAX)	RELEASE FORCE (MIN)
	LENGTH OF LEVER	OVER TRAVEL (MIN)	PRE TRAVEL (MAX)	OPERATING POSITION	FREE POSITION (MAX)	203	203	203
P00	N/A	0.6	1.2	8.4 ± 0.3	9.9	0.2	203	50
T00	11.9	0.6	3.2	8.8 ± 0.9	11.1	0.5	98	21
T05	17.40	0.9	4.3	8.8 ± 1.1	12	0.6	82	16
T07	19.40	1	4.8	8.8 ± 1.2	12.4	0.7	66	13
T13	25.5	1.6	6.3	8.8 ± 1.6	13.5	0.9	54	11
T19	33.3	1.95	8	8.8 ± 2.0	15	1.75	40	5
T28	40.7	2.1	10.1	8.8 ± 2.6	16.3	2.3	39	8
T43	55.9	2.9	13.8	8.8 ± 3.5	19.1	3.6	33	7
S26	18.6	1	4.6	10.7 ± 1.2	14.1	0.65	68	14
A05	17.20	0.9	4.3	14.5 ± 1.1	17.7	0.6	72	15

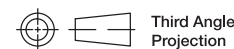

Third Angle
Projection
Dimensions are shown: mm
Specifications and dimensions subject to change



LCS Series Subminiature Sealed Snap-acting Switches

TERMINATIONS

S SOLDER

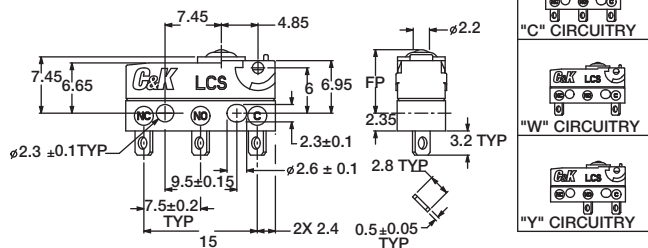

Q QUICK CONNECT 2.8mm / 0.110"

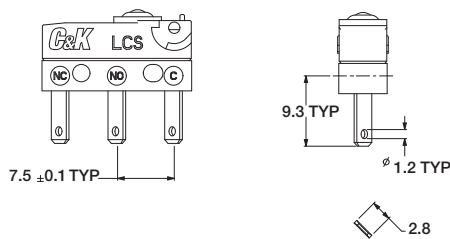

P PC THRU HOLE

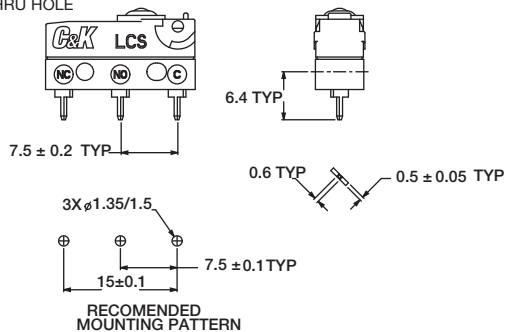

Z or W "A" WIRE ORIENTATION

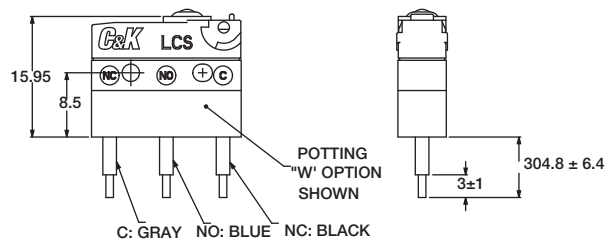

Z or W "B" WIRE ORIENTATION
"Y" OR "W" CIRCUITRY

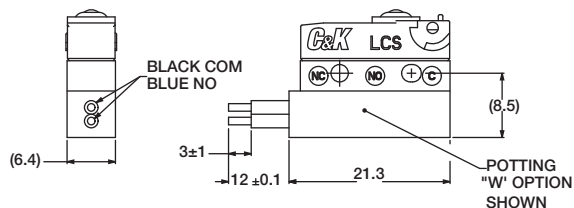

Z or W "C" WIRE ORIENTATION
"Y" OR "W" CIRCUITRY

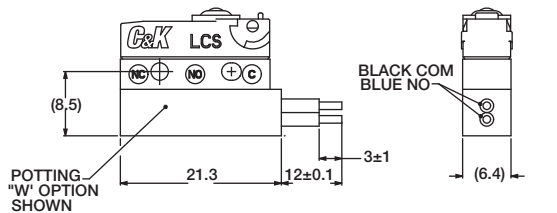

Z or W "B" WIRE ORIENTATION
"C" CIRCUITRY

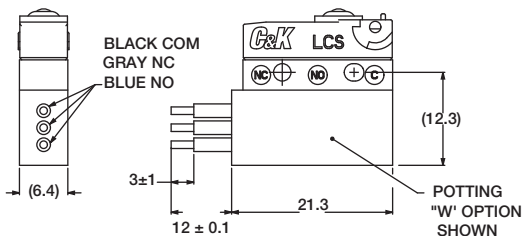

Z or W "C" WIRE ORIENTATION
"C" CIRCUITRY

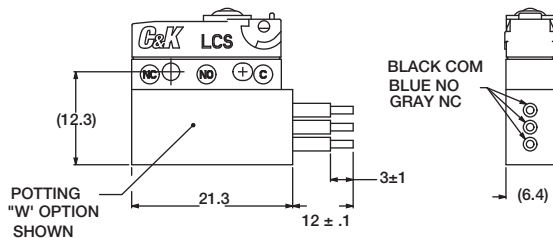

CIRCUITRY

- C** SPDT (Single Pole, Double Throw)
- W** SPST N.C. (Single Pole, Single Throw, Normally Closed)
- Y** SPST N.O. (Single Pole, Single Throw, Normally Open)



Third Angle
Projection

Dimensions are shown: mm
Specifications and dimensions subject to change

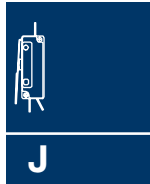

Snap-acting