



EVERLIGHT ELECTRONICS CO.,LTD.

# DATA SHEET

PART NO. : 209SDRSYGW/S530-A3

DATE : 2004/5/21

DEPARTMENT : CHR&D1

REVISION : 1

<b>RECEIVED</b>			
<input checked="" type="checkbox"/> MASS PRODUCTION			
<input type="checkbox"/> PRELIMINARY			
<input type="checkbox"/> CUSTOMER DESIGN			
DEVICE NUMBER : CDLE-020-707			
PAGE : 7			
CUSTOMER	DESIGNER	CHECKER	APPROVER

REV.	DESCRIPTION	RELEASE DATE

OFFICE: 7C BUILDING, LIAN HUA PORT INDUSTRIAL DISTRICT, LIAN HUA SHAN  
 BONDED PRICCESSING ZONE PAN YU, GUANG ZHU, CHINA  
 TEL. : (020)84860913,84860914  
 FAX : (020)84860600  
[http : //www.everlight.com](http://www.everlight.com)



# Technical Data Sheet

## 3.0mm Multi-Color Round Type LED Lamps

### 209SDRSYGW/S530-A3

#### ■ Features :

- Two chips are matched for uniform light output, wide viewing angle
- Long life-solid state reliability
- I.C. compatible/Low power consumption

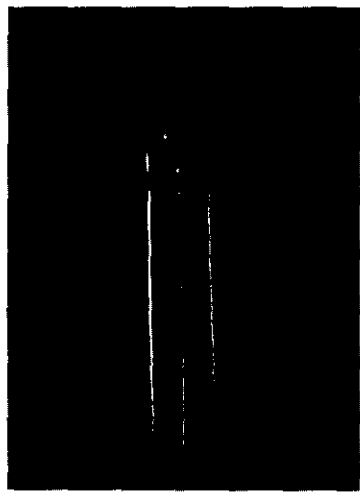

#### ■ Descriptions :

- The 209 LED lamps contain two integral chips and is available as both bicolor and bipolar types.
- The Super Deep-Red and Super Yellow Green light is emitted by diodes of AlGaInP and AlGaInP respectively.
- Type of bipolar lamps are both White Diffused and Color Diffused while the bicolor are White Diffused.

#### ■ Applications :

- TV set
- Monitor
- Telephone
- Computer

PART NO.	Chip		Lens Color
	Material	Emitted Color	
209SDRSYGW/S530-A3	AlGaInP	Super Deep-Red	White Diffused
	AlGaInP	Super Yellow Green	



# Technical Data Sheet

## 3.0mm Multi-Color Round Type LED Lamps

### 209SDRSYGW/S530-A3

#### Package Dimensions

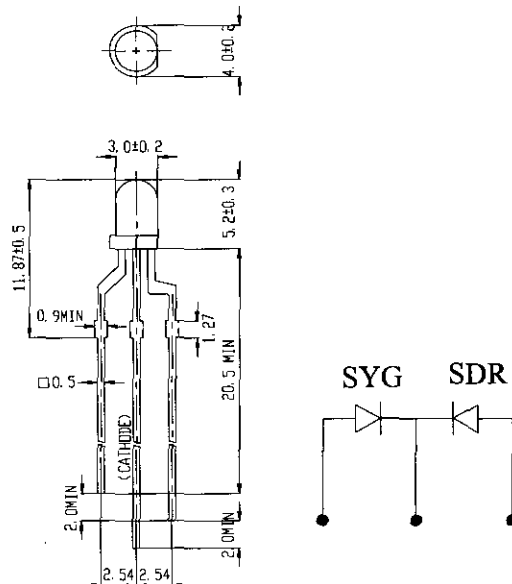

**Notes:** 1. All dimensions are in millimetres

2. An epoxy meniscus may extend about 1.5mm(0.059") down to the lead.
3. Tolerances unless Dimension ±0.25mm.

#### The Hyper Red and Super Yellow Green

Parameter	Symbol	Rating		Unit
		SDR/S530	SYG/S530	
Current	I <sub>F</sub>	SDR/S530	25	mA
		SYG/S530	25	
Operating Temperature	T <sub>opr</sub>	-40 to +85		°C
Storage Temperature	T <sub>stg</sub>	-40 to +100		°C
Soldering Temperature	T <sub>sol</sub>	260 ± 5		°C
Electrostatic Discharge	ESD	2000		V
Power Dissipation	P <sub>d</sub>	SDR/S530	60	mW
		SYG/S530	60	
Peak Forward Current	I <sub>F</sub> (Peak)	SDR/S530	160	mA
		SYG/S530	160	
Reverse Voltage	V <sub>R</sub>	5		V

Note: \*1:I<sub>FP</sub> Conditions --Pulse Width ≤ 1msec and Duty ≤ 1/10.

\*2:Soldering time ≤ 5 seconds.



Technical Data Sheet  
3.0mm Multi-Color Round Type LED Lamps

**209SDRSYGW/S530-A3**

**Electro-Optical Characteristics (Ta=25°C)**

Parameter	Symbol	Min.	Typ.	Max.	Unit	Condition
Luminous Intensity	Iv SDR/S530	25	50	/	mcd	If= 20 mA
	SYG/S530	16	32	/		
Viewing Angle	2θ 1/2	/	80	/	deg	If= 20 mA
Peak Wavelength	λ p SDR/S530	/	650	/	nm	If= 20 mA
	SYG/S530	/	575	/		
Dominant Wavelength	λ d SDR/S530	/	639	/	nm	If= 20 mA
	SYG/S530	/	573	/		
Spectrum Radiation Bandwidth	Δ λ SDR/S530	/	20	/	nm	If= 20 mA
	SYG/S530	/	20	/		
Forward Voltage	V <sub>F</sub> SDR/S530	/	2.0	2.4	V	If= 20 mA
	SYG/S530	/	2.0	2.4		
Reverse Current	I <sub>R</sub>	/	/	10	μ A	V <sub>R</sub> = 5 V



# Technical Data Sheet

## 3.0mm Multi-Color Round Type LED Lamps

### 209SDRSYGW/S530-A3

#### Typical Electro-Optical Characteristic Curves:

( SDR )

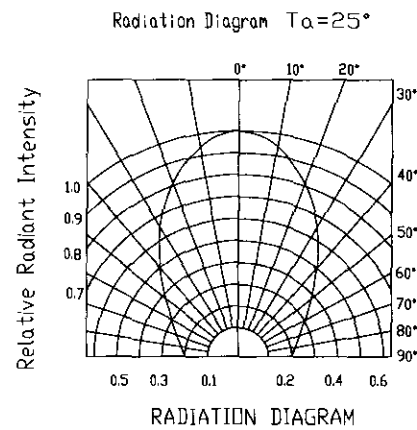
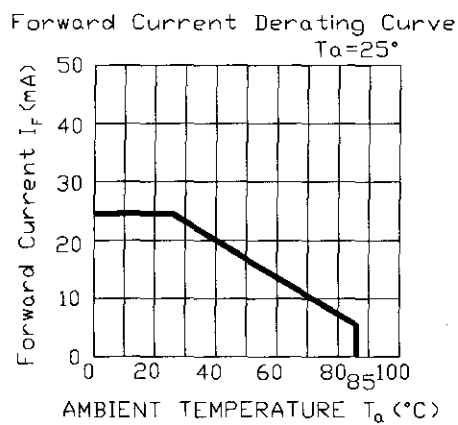
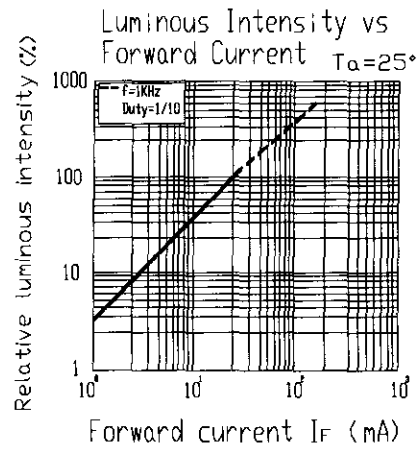
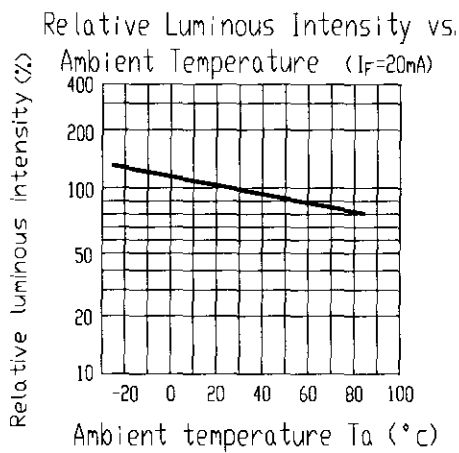
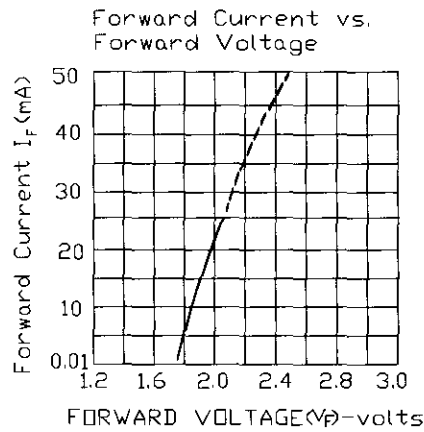
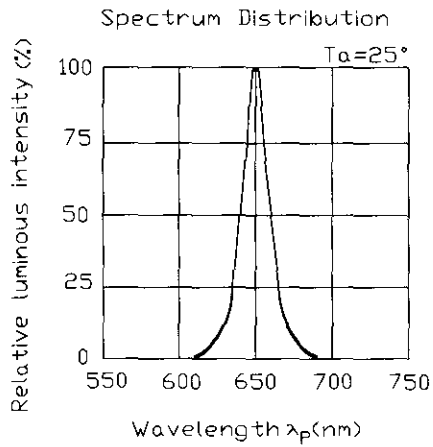



# Technical Data Sheet

## 3.0mm Multi-Color Round Type LED Lamps

### 209SDRSYGW/S530-A3

#### Typical Electro-Optical Characteristic Curves:

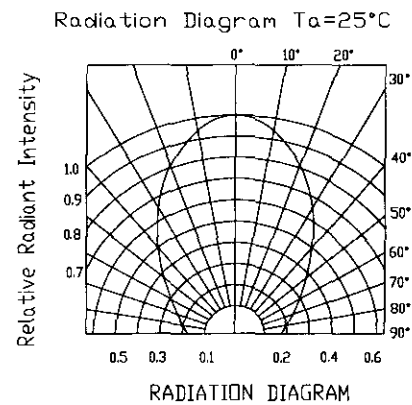
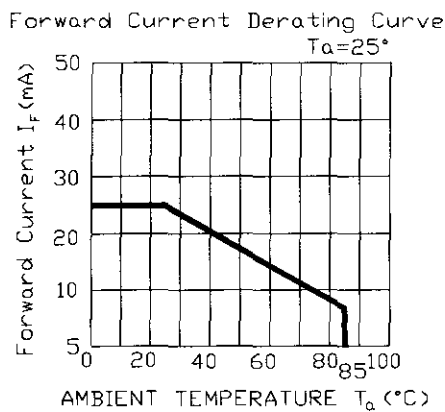
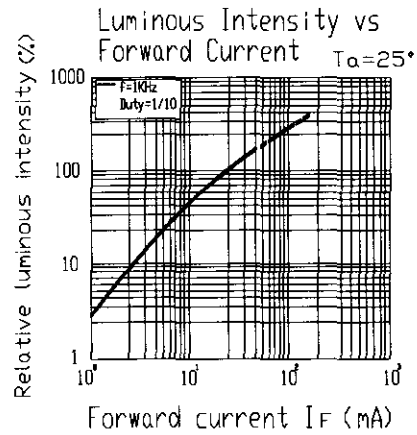
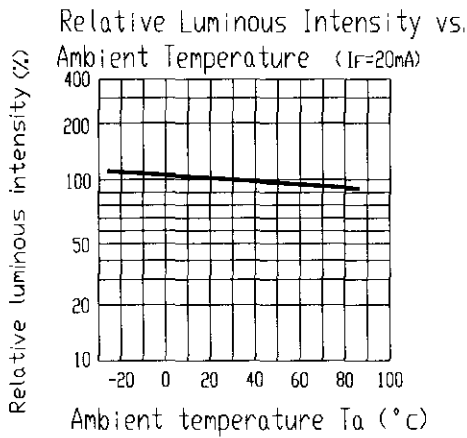
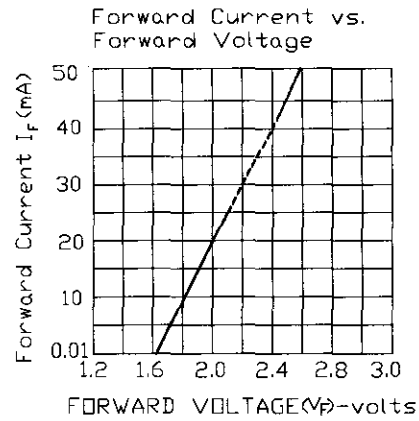
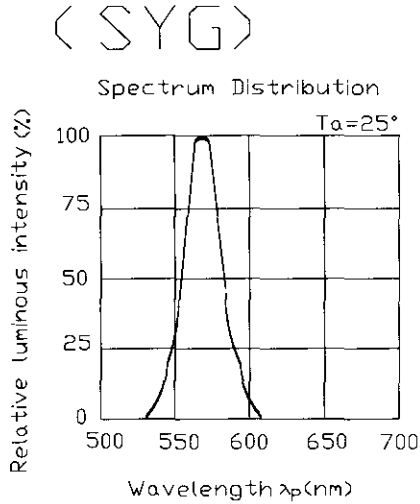



Technical Data Sheet  
3.0mm Multi-Color Round Type LED Lamps

**209SDRSYGW/S530-A3**

■ Reliability test items and conditions:

NO	Item	Test Conditions	Test Hours/Cycle	Sample Size	Ac/Re
1	Solder Heat	TEMP : 260°C ± 5 °C	10 SEC	76 PCS	0/1
2	Temperature Cycle	H : +100°C 15min § 5 min L : -40°C 15min	300 CYCLES	76 PCS	0/1
3	Thermal Shock	H : +100°C 5min § 10 sec L : -10°C 5min	300 CYCLES	76 PCS	0/1
4	High Temperature Storage	TEMP : 100°C	1000 HRS	76 PCS	0/1
5	Low Temperature Storage	TEMP : -40°C	1000 HRS	76 PCS	0/1
6	DC Operating Life	TEMP : 25°C IF = 20mA	1000 HRS	76 PCS	0/1
7	High Temperature / High Humidity	85°C / 85% RH	1000 HRS	76 PCS	0/1



# Technical Data Sheet

## 3.0mm Multi-Color Round Type LED Lamps

**209SDRSYGW/S530-A3**

### Packing Quantity Specification

1.500PCS/1Bag , 6Bags/1Box

2.10Boxes/1Carton

### Label Form Specification



CPN:

P/N:



209SDRSYGW/S530-A3

QTY:



CAT:

HUE:

REF:

LOT NO: EL



MADE IN TAIWAN

CPN: Customer's Production Number

P/N : Production Number

QTY: Packing Quantity

CAT: Ranks

HUE: Peak Wavelength

REF: Reference

LOT No: Lot Number

MADE IN TAIWAN: Production Place

### Notes

1. Above specification may be changed without notice. EVERLIGHT will reserve authority on material change for above specification.
2. When using this product, please observe the absolute maximum ratings and the instructions for using outlined in these specification sheets. EVERLIGHT assumes no responsibility for any damage resulting from use of the product which does not comply with the absolute maximum ratings and the instructions included in these specification sheets.
3. These specification sheets include materials protected under copyright of EVERLIGHT corporation. Please don't reproduce or cause anyone to reproduce them without EVERLIGHT's consent.

EVERLIGHT ELECTRONICS CO., LTD.

Office: No 25, Lane 76, Sec 3, Chung Yang Rd,  
Tuchene, Tainpei 236, Taiwan. R.O.C

Tel: 886-2-2267-2000, 2267-9936

Fax: 886-2267-6244, 2267-6189, 2267-6306

<http://www.everlight.com>