

ISOMETRIC VIEW

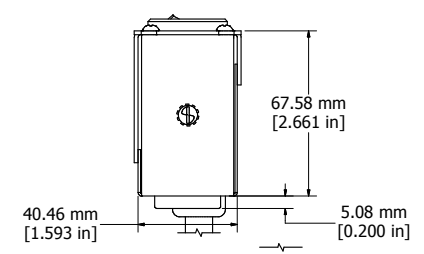

ASSEMBLY - VIEW FROM SIDE

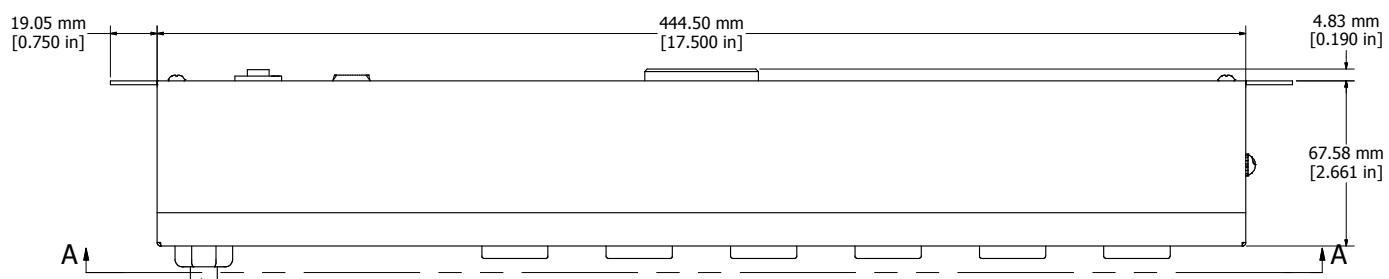
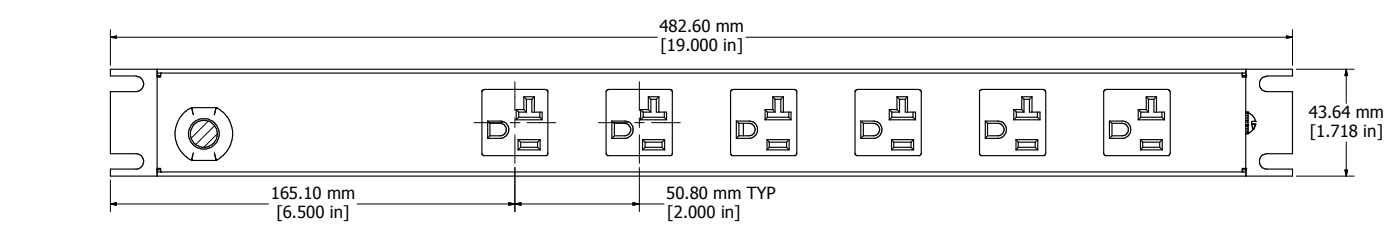
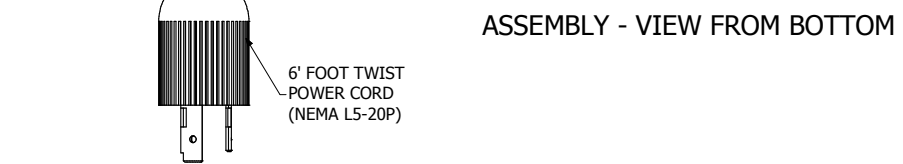

1589T6C1BKRRAM
Finish - Front - Black Painted Steel
Back - Black Painted Steel
Rated - 125 VAC, 60 Hz, 20 Amps
Approvals - cURus Recognized to Standard UL1363 & C22.2 No. 21-95
Cord Length
6' Foot Twist Power Cord (NEMA L5-20P)

HAMMOND MANUFACTURING™

1589T6C1BKRRAM

www.hammondmfg.com