

Small Signal Diode



Features

- ↪ Meet IEC61000-4-2 (ESD) ±15kV (air), ±8kV (contact)
- ↪ Meet IEC61000-4-4 (EFT) rating. 40A (5/50ns)
- ↪ Protects two directional I/O lines
- ↪ Working Voltage : 5V
- ↪ Pb free version, RoHS compliant, and Halogen free

Mechanical Data

- ↪ Case :SOT-143 package, molded plastic
- ↪ Terminal: Matte tin plated, lead free.
- ↪ High temperature soldering guaranteed: 260°C/10s
- ↪ Molding Compound Flammability Rating : UL 94V-0
- ↪ Weight : 10mg (approximately)
- ↪ Marking Code : SL3

Applications

- ↪ USB Power & Data Line Protection
- ↪ I²C Bus Protection
- ↪ Video Line Protection
- ↪ Microcontroller Input Protectionns
- ↪ T1/E1 secondary IC side Protection
- ↪ ISDN S/T Interface
- ↪ WAN/LAN Equipment
- ↪ Ethernet 10BaseT

Ordering Information

Part No.	Package	Packing	Packing Code	Marking
TESDB5V0A	SOT-143	3K / 7" Reel	RBG	SL3

Maximum Ratings and Electrical Characteristics

Rating at 25°C ambient temperature unless otherwise specified.

Maximum Ratings

Type Number	Symbol	Value	Units
Peak Pulse Power (tp=8/20µs waveform)	P _{PP}	200	W
Peak Pulse Current (tp = 8/20µs)	I _{PP}	10	A
ESD per IEC 61000-4-2 (Air) ESD per IEC 61000-4-2 (Contact)	V _{ESD}	±15 ± 8	KV
Junction Temperature Range	T _J	-55 to + 150	°C
Storage Temperature Range	T _{STG}	-55 to + 150	°C

Electrical Characteristics

Type Number	Symbol	Min	Max	Units
Reverse Stand-Off Voltage	V _{RWM}	-	5	V
Reverse Breakdown Voltage	V _(BR)	6	-	V
Reverse Leakage Current	I _R	-	5	µA
Clamping Voltage	V _C	I _{PP} = 1A	9.8	V
		I _{PP} = 3A	17	
Junction Capacitance	C _J	3 (Typ.)		pF

Notes: 1. The suggested land pattern dimensions have been provided for reference only, as actual pad layouts may vary depending on application.

SOT-143

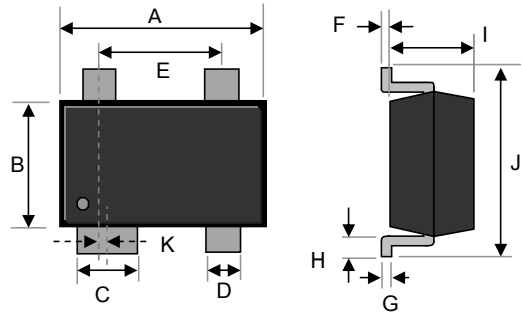

Dimensions	Unit (mm)		Unit (inch)	
	Min	Max	Min	Max
A	2.800	3.040	0.110	0.120
B	1.200	1.400	0.047	0.055
C	0.760	0.940	0.030	0.037
D	0.300	0.510	0.012	0.020
E	2.100	2.640	0.083	0.104
F	0.013	0.015	0.001	0.001
G	0.080	0.200	0.003	0.008
H	0.400	0.600	0.016	0.024
I	0.750	1.070	0.030	0.042
J	2.100	2.640	0.083	0.104
K	0.2 (BSC)		0.008(BSC)	

Pin Configuration & PAD Layout

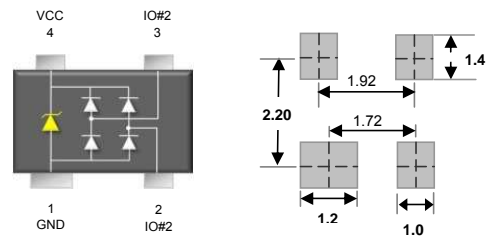

Unit : mm

Small Signal Diode

Rating and Characteristic Curves

FIG 1. Admissible Power Dissipation Curve

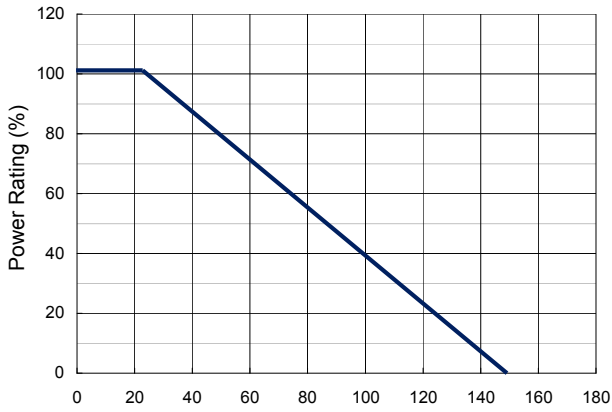

FIG 2. Pulse Waveform

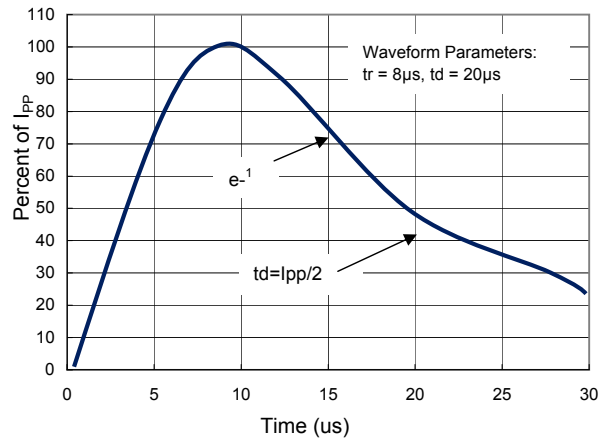

FIG 3. Clamping Voltage vs. Peak Pulse Current

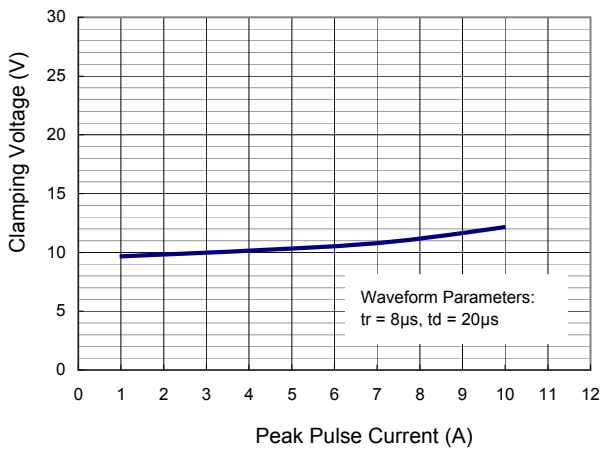
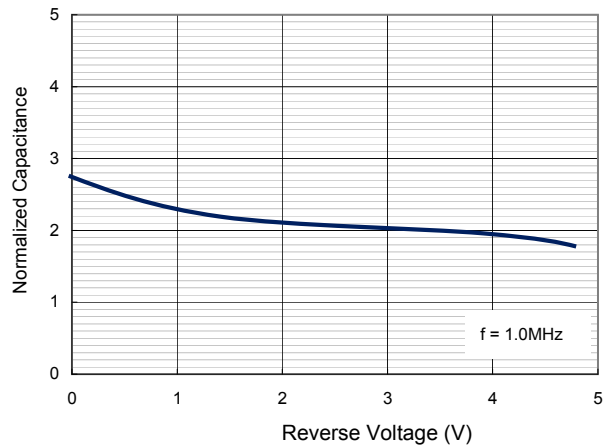

FIG 4. Typical Junction Capacitance



Small Signal Diode

Applications Information

- ◇ Designed for the protect two data lines from transient over-voltages by clamping them to a fixed reference.
- ◇ Data lines are connected at pins 2 and 3.
- ◇ The negative reference (REF1) is connected at pin 1 and which should be connected directly to a ground plane on the board for best results.
- ◇ The positive reference (REF2) is connected at pin 4.

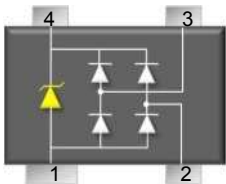

Pin	Definition
2, 3	I/O Lines
1	Ground
4	VCC

Typical Application

Schematic Diagram for Gigabit Ethernet ESD Protection

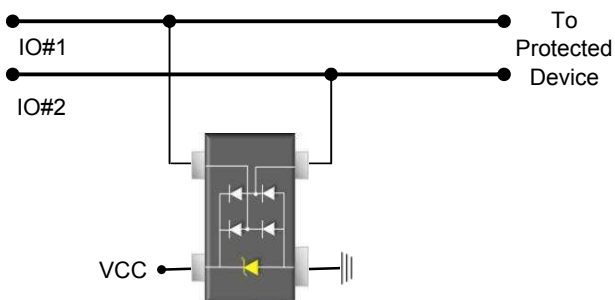

◇ Data Line and Power Supply Protection Using VCC

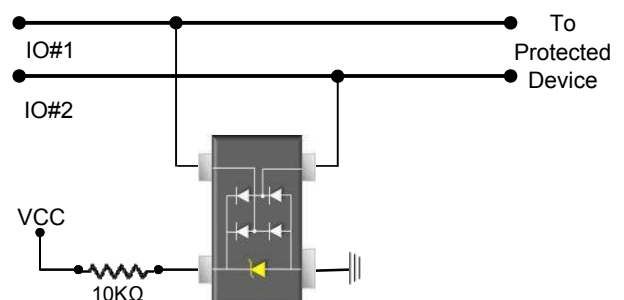

◇ Data Line Protection with Bias and Power Supply Isolation Resistor

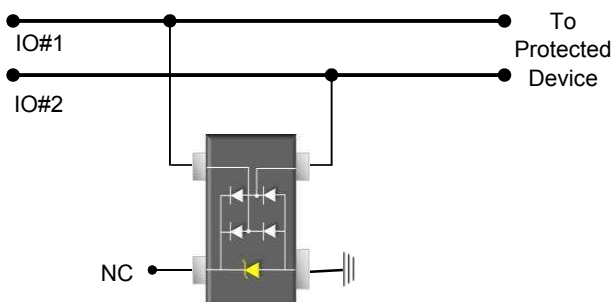

◇ Data Line Protection Using Internal ESD Diode

Small Signal Diode

Carrier & Reel specification

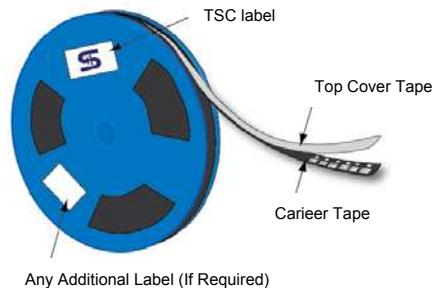

Item	Symbol	Dimension(mm)
Carrier depth	K	1.22 Max.
Sprocket hole	D	1.50 +0.10
Reel outside diameter	A	180 ± 1
Reel inner diameter	D1	50 Min.
Feed hole width	D2	13.0 ± 0.5
Sprocket hole position	E	1.75 ± 0.10
Sprocket hole pitch	P0	4.00 ± 0.10
Embossment center	P1	2.00 ± 0.10
Overall tape thickness	T	0.6 Max.
Tape width	W	8.30 Max.
Reel width	W1	14.4 Max.

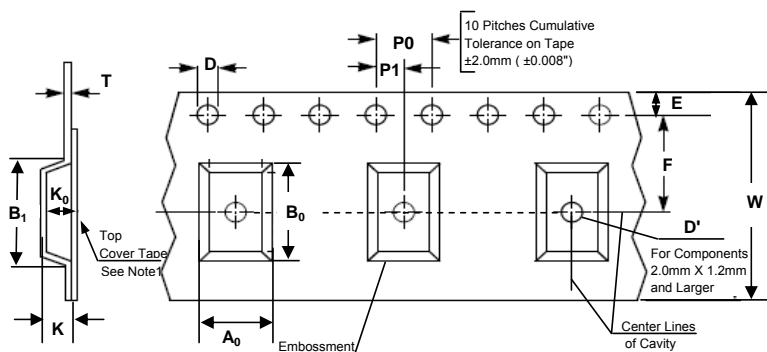

For Machine Reference Only
Including Draft and RADLL
Concentric Around B₀

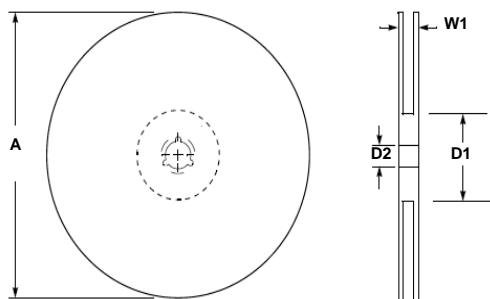
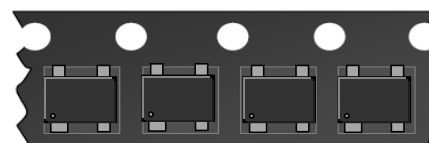

Note 1: A₀, B₀, and K₀ are determined by component size. The clearance between the components and the cavity must be within 0.05 mm min. to 0.5 mm max. The component cannot rotate more than 10° within the determined cavity.

Note 2: If B₁ exceeds 4.2 mm(0.165") for 8 mm embossed tape, the tape may not feed through all tape feeders.